

TECHNICAL DATA SHEET

SILHOUETTE CABINETS

BOX CONTENTS: SILHOUETTE Cabinet | Instructions booklet | Toughened Glass Shelves | 1x Wall Bracket with Fixing Screws

FAQ's	Units	SCH5090A	SCH4590P	SCH50145P
Internal dimensions (W x H x D)	mm	484 x 824 x 109	434 x 884 x 109	484 x 1428 x109
Shelf dimensions (W x H x D)	mm	476 x 95 x 5	426 x 95 x 5	476 x 95 x 5
Number of Shelves	units	2	2	3
Max shelf spacing	mm	383	185	380
Distance between door hinges	mm	415	265	485 and 350
Individual door dimensions (W x H x D)	mm	500 x 900 x 6	450 x 900 x 6	500 x 1450 x 6
What is the thickness of the mirror glass door?	mm	3+3		
Door opening angle	°	125°		
Door opening	-	LH	Both . Cabinet can be hung for the door to open RH or LH.	
Depth with door fully open	mm	655	605	655
Hanging bracket dimensions	mm	300	250	300
Where is the switch sensor located?	-	IR sensor is located underneath the cabinet (RH side)	IR sensor is located to one side of the cabinet. Opposite side to door hinges.	
What is the minimum distance required from the IR sensor and adjacent wall or obstruction to ensure correct function?	mm	150		
What's the maximum weight load recommended	Kg	15		
Can the LED lighting be replaced?	-	No		
Can the switch sensor be replaced?	-	Yes		
What size fuse should I use?		Seek advice from an electrician		
Does the cabinet have a demister pad?	-	No		
Are illuminated cabinets/mirrors supplied with mains cable?	-	All illuminated cabinets/mirrors are supplied with a removeable 500mm mains cable. There is ample storage for excess cable in the back of the unit.		

TECHNICAL DATA SHEET

ELECTRICAL SPECIFICATION

	Input Voltage	Lamp Type	Total Wattage (W)	LEDs (W)	Shaver Socket (W)	UBS Port (W)	LED (lm)	Energy Rating	CCT (K)	CRI	IP Rating	Electrical Class
SHC5090A	220-240V 50Hz	12V DC LED Lamp	63.7	11.7	20	32	702	G	3000-6000	80+	IP44	Class I
SHC4590P	220-240V 50Hz	12V DC LED Lamp	63.4	11.4	20	32	684	G	3000-6000	80+	IP44	Class I
SHC50145P	220-240V 50Hz	12V DC LED Lamp	70.3	18.3	20	32	1100	G	3000-6000	80+	IP44	Class I

TECHNICAL DRAWINGS

SHC5090A

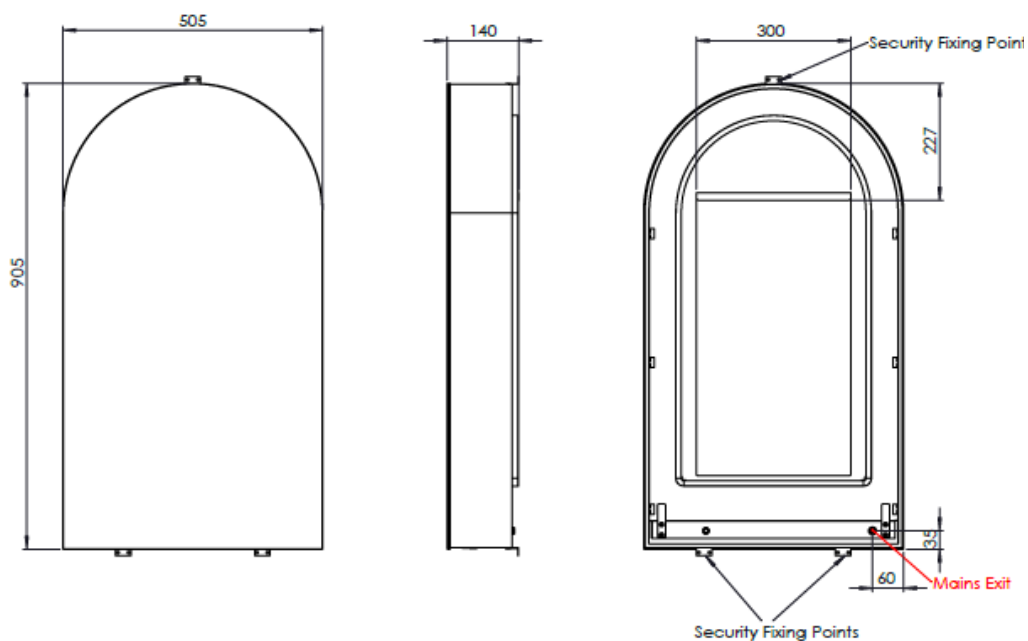

SHC4590P

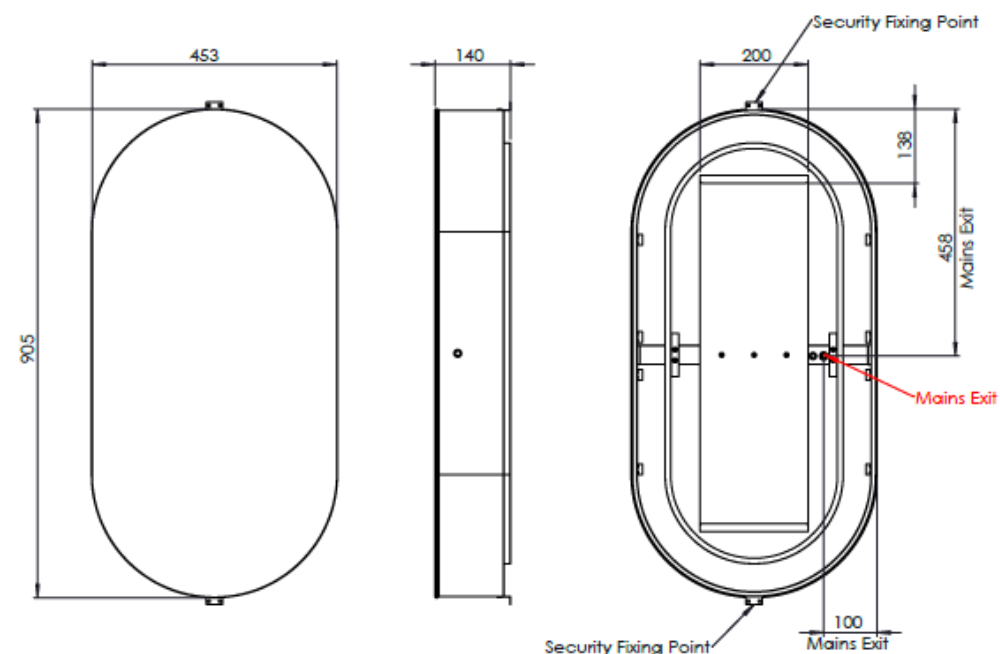

TECHNICAL DATA SHEET

SHC50145P

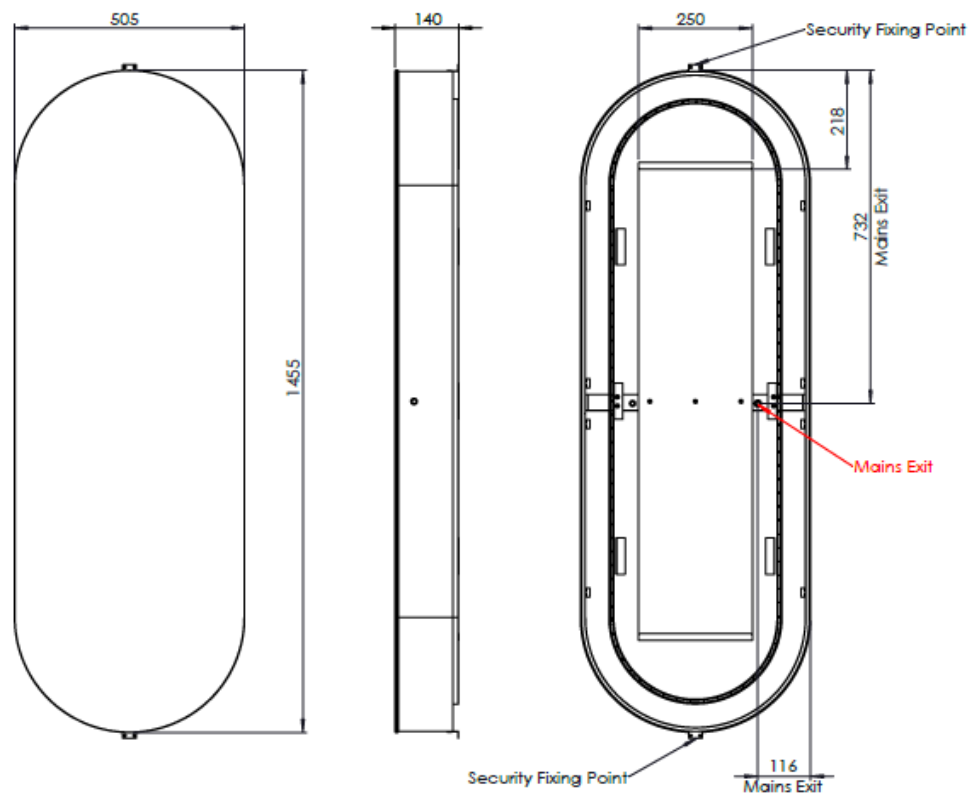

MATERIALS

6mm Glass Door, PVC Backed

Glass Internal Back Panel

Gunmetal Aluminium Carcass

Silicon Diffuser

Please note:

- Dimensions are subject to change. Customers are advised to measure actual product dimensions before commencing installation.
- Fixing point dimensions are for guidance only/the positions of wall fixing must be checked when product is received.
- The LED (lm) values represent the output of the LED. Actual product level Lumen output may vary depending on the diffuser material i.e., glass or acrylic.