

Technical Data Sheet

AVANT - AV44AL

Whats in the box: 1x Cabinet + Fixings

R2

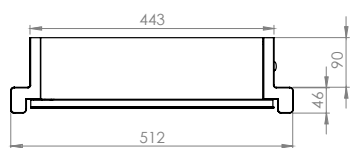

Diagrams not to scale. All dimensions in mm (tolerance of +/-5mm)

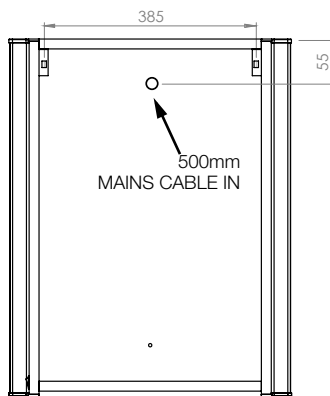
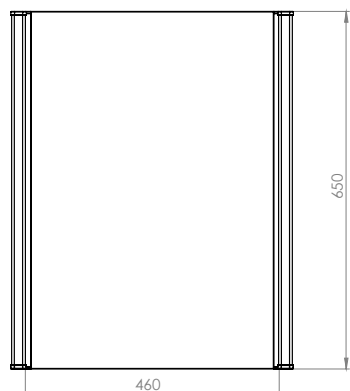

ROCKER SWITCH

Materials

Carcass: Extruded Aluminium

Door: MDF

Mirror: Mirror Glass

Carcass End Caps: Painted Plastic

**Dimensions are subject to change, customers are advised to measure actual product before commencing installation.

***Fixing point dimensions are for guidance only/the positions of wall fixing must be checked when product is received.

FAQ's

- | | |
|---|--|
| Q: Internal dimensions (Depth x Width). | A: 100 x 405mm. |
| Q: Shelf dimensions (Length x Width x Depth). | A: 396 x 95 x 5mm. |
| Q: Max shelf spacing. | A: Shelves adjustable in increments of 70mm, up to a maximum of 350mm. |
| Q: Distance between hinge centres. | A: 400mm. |
| Q: Door dimensions (Height x Width x Depth). | A: 650 x 440 x 15mm. |
| Q: Door opening angle. | A: 90°. |
| Q: Depth with door fully open. | A: 577mm. |
| Q: Hanging brackets centres. | A: 385mm. |
| Q: What is the thickness of the cabinet door glass? | A: 3mm PVC back filmed (On 12mm MDF). |

Cabinets with painted finish do not have a RAL code as the colour is unique to R2.

- | | |
|---|--|
| Q: Is the cabinet IP44 rated? | A: Yes, it can be placed in zone 2 and outside zones. |
| Q: What size fuse should I use? | A: We cannot recommend fuse size as each installation is different. A qualified Electrician should be consulted in accordance with IEE 7671. |
| Q: What is the total power consumption? | A: 55Watts. |
| Q: Does the cabinet have an energy rating? | A: The energy rating of LED's used in this product are rated as 'A'. |
| Q: What is the colour of the light and the Kelvin rating? | A: 6000k Cool White. |
| Q: Can the LED lighting be replaced? | A: Yes, see on last page instruction packages available for this mirror. |
| Q: Can the IR sensor/rocker switch be repositioned? | A: No. |

All Illuminated cabinets are supplied with approximately 500mm of mains cable. This can be removed for the customer to make their own connection to their mains supply. There is ample storage for excess cable in the back of the unit.