

Technical Data Sheet

DRIVE Floor Mounted Unit Including Basin

What's in the box: 1x DR4010.X + Handle + Fixings

R2

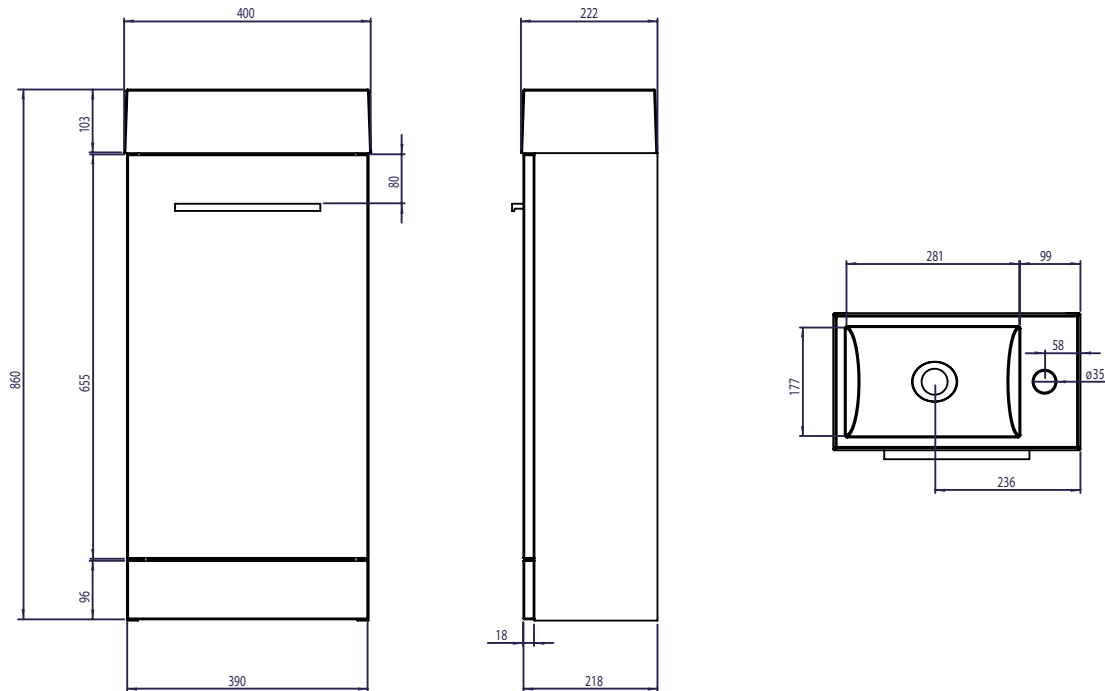

Diagrams not to scale
All dimensions in mm
Tolerance of +/-5mm

Materials

Carcass: 18mm Painted MDF

Fascia Components: 18mm Painted MDF

Basin: Isocast

*Dimensions are subject to change, customers are advised to measure actual product before commencing installation.

**Fixing point dimensions are for guidance only/the positions of wall fixing must be checked when product is received.

FAQs

Q: How big is the plumbing void at the back of the furniture?

A: 52mm.

Q: Is the handle fitted?

A: No, the handle needs fixing. The door includes 2 holes drilled through and spaced 224mm apart. Handles are included with the unit.

Q: Is the door reversible?

A: No, only left hand hinges.

Q: How deep is the unit with door open?

A: Approx 610mm (at 90 degrees).

Q: Is the shelf removable?

A: No, there is one fixed shelf.

Q: Can the door be adjusted?

A: The door can be adjusted as detailed in the supplied instructions.

Q: How do I fix the unit to the wall?

A: You can secure it to the wall drilling through the back brace.

Q: What is the interior finish of the unit?

A: The unit interior is the same finish as the exterior.

Q: What is the maximum water depth of the basin?

A: 64mm up to the overflow.

Q: What is the internal depth?

A: The internal depth is 80mm.

Q: Whats is the width of the Tapledge?

A: The Tapledge is 99mm wide.

Q: What is the distance from the Taphole centre to Basin Waste?

A: 178mm.

NOTE: Colours unique to R2 - No RAL Code available