

Shower Handset Kit

INSTALLATION & AFTERCARE INSTRUCTIONS

Please retain for future reference

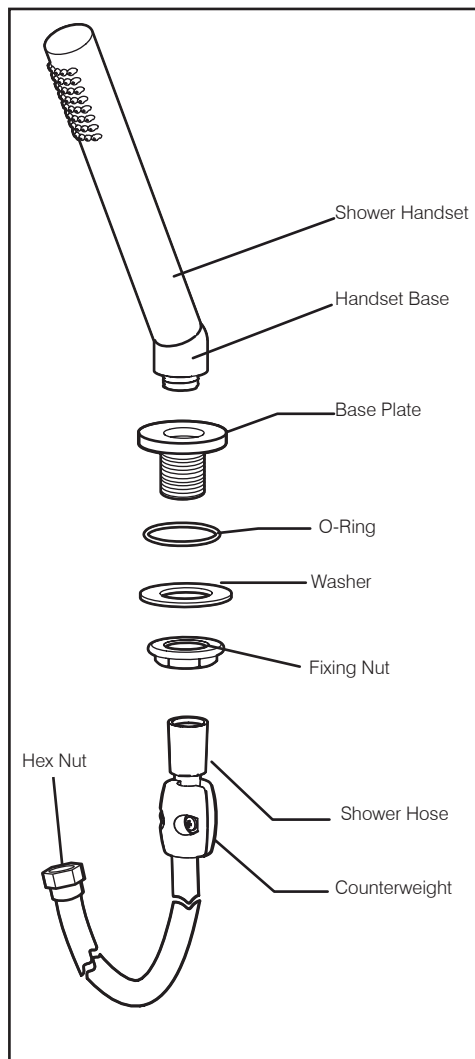

Before installation, determine the position of the shower handset and drill any necessary holes in the bath tub tap deck.

1. Disassemble the washer and fixing nut from the base plate assembly. With the washer and fixing nut on the underside of the bath tub and the base plate above, secure the base plate to the tap deck.

2. Remove the hex-nut end of the shower hose - this will allow the hose to be passed through the base plate. The opposite end of the hose has a tapered fixing which will prevent the other end passing through the base plate. Re-assemble the hex nut to the hose.

3. Attach the counter weight to the shower hose, allowing enough room for the hose to be retracted to an appropriate length later.

4. Assemble the shower handset to the handset base. If the handset does not align properly, loosen the grub screw on the handset base. This will allow the handset to be rotated and adjusted. After any adjustments have been made, re-tighten the grub screw.

5. Connect the hex nut end of the hose to the water supply. Connect the tapered end to the thread on the handset base. PTFE tape can be used to ensure a water-tight seal.

6. Test that the handset and hose can be removed from the base plate freely, and check the system for any leaks.