

# Technical Data Sheet

# ROPER RHODES®

Event Click Round 2F Shower system with Shower Head outlet and Handset - SVSET156

No.	Description	Code	Fixings Included
1	Event Click Round 2F Shower system with Shower Head outlet and Handset	SVSET156	YES



Inlet Pressure	Flow Rate (l/min)
1bar	9.7
2bar	14.0
3bar	17.0
4bar	19.0
5bar	21.0

Flow from valve may vary depending on accessories and domestic supply.

## Dimensions - SVSET156

Diagrams not to scale. All dimensions in mm (tolerance of +/-5mm)

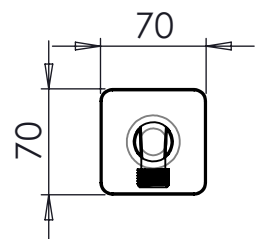
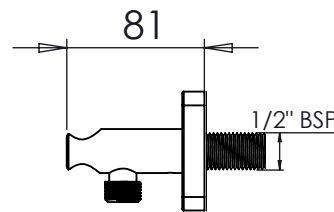
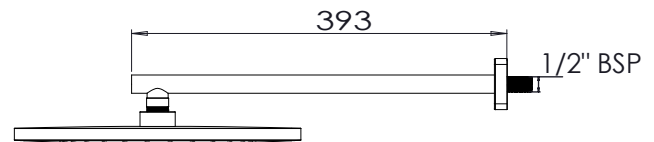
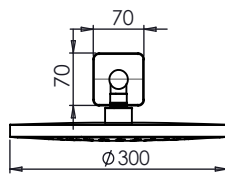
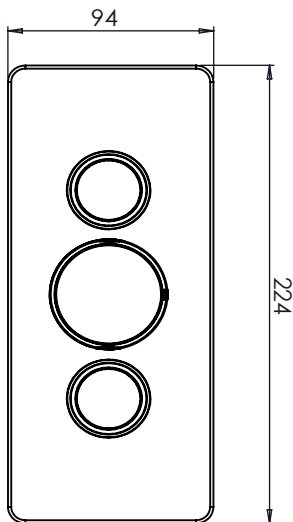

## FAQs

**What is the size of the connections?** The valve uses 1/2" connections.

**Can I have both shower options on at the same time?** Yes

**What size Pipework do i need?** 15mm

**Is it suitable for stud walls?** It is recommended you use CLS size 89mm depth within the wall

**Does the valve include isolation points?** Yes

**What is the recommended operating pressure?** 1.0bar

## Components

Valve - RR14

Chrome Cover Plate - SVCOMP3

Brass Handset Holder - SVACS17

Handset - SVHEAD38

Easy Clean PVC Shower Hose - SVHOSE02

Adjustable Shower Arm - SVARM11

Shower Head - SVHEAD35