

# Technical Data Sheet

## Henley Shower Systems

# ROPER RHODES®

No.	Description	Code	Fixings Included
1	Henley Single Function Concealed Shower System	SVSET53	YES



**FLOW RATE DATA IS TESTED UNDER  
LABORATORY CONDITIONS: ACTUAL  
FLOW RATE MAY VARY DEPENDING ON  
DOMESTIC SUPPLY AND ACCESSORIES**

Inlet Pressure	Flow Rate (l/min)
0.3bar	6.90
0.4bar	7.97
0.5bar	8.91
1bar	12.60
2bar	17.82
3bar	18.80

### Dimensions - SVSET53

Diagrams not to scale. All dimensions in mm (tolerance of +/-5mm)

\*Dimensions are subject to change, customers are advised to measure actual product before commencing installation.

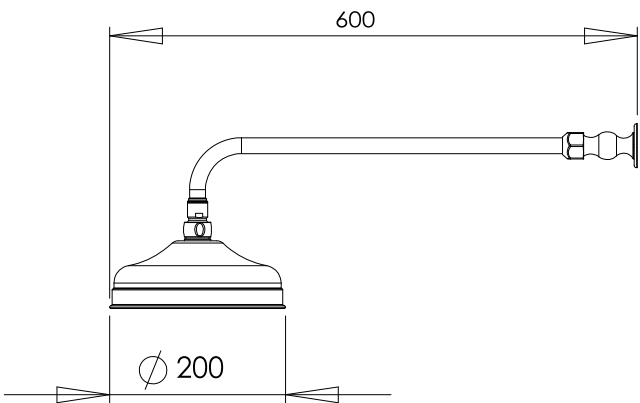
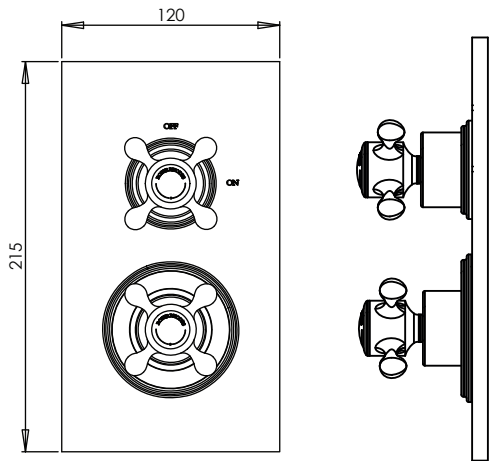

### FAQs

- What is the valve outlet dimension?** 1/2" BSP
- What is the valve inlet dimension?** 3/4" BSP
- Height of shower handset (in holder)?** Adjustable
- What is the recommended minimum pressure?** 0.3bar
- What material are the handles made from?** Chrome-Plated Brass
- Can the shower arm length be adjusted?** Yes, the shower arm can be cut down prior to fitting.

### Components

- Dual Function Thermostatic Shower Valve - SV3114:
  - Brass thermostatic push button shower valve - RR14
  - Chrome plated zinc cover plate - SVCOMP1
- Adjustable Brass Fixed Arm - SVARM01**
- 230mm Shower Head - SVHEAD35
- Brass Riser Rail - SVRAIL07
- Three Function Shower Handset - SVHEAD38
- Easy Clean PVC Shower Hose -SVHOSE02
- Brass Wall Elbow - SVACS03

# Technical Data Sheet

## Henley Shower Systems

# ROPER RHODES®

No.	Description	Code	Fixings Included
1	Henley Dual Function Concealed Diverter Shower System	SVSET52	YES



**FLOW RATE DATA IS TESTED UNDER LABORATORY CONDITIONS: ACTUAL FLOW RATE MAY VARY DEPENDING ON DOMESTIC SUPPLY AND ACCESSORIES**

Inlet Pressure	Flow Rate (l/min)
0.5bar	8.84
1bar	12.50
2bar	17.68
3bar	18.40
4bar	25.00
5bar	27.70

## Dimensions - SVSET52

Diagrams not to scale. All dimensions in mm (tolerance of +/-5mm)

\*Dimensions are subject to change, customers are advised to measure actual product before commencing installation.

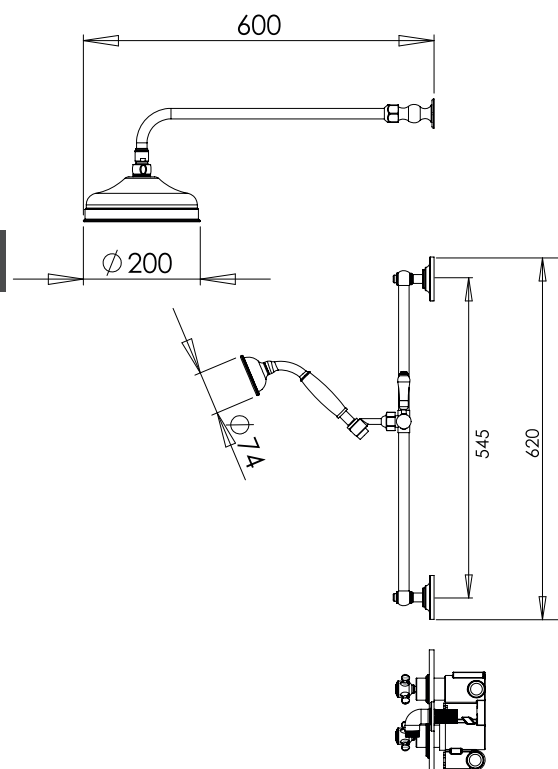
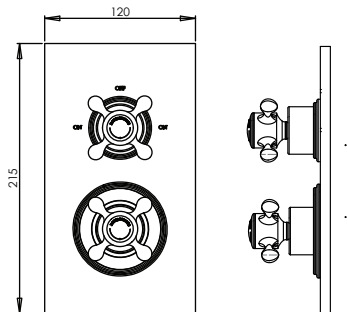

## FAQs

**What is the valve inlet dimension?** 1/2" BSP - 15mm pipework

**What is the valve outlet dimension?** 1/2" BSP threaded outlet

**Can the shower arm and riser rail length be adjusted?** Yes, the shower arm and riser rail can be cut down prior to fitting.

**What is the hose length?** 1.5m

**What is the height of the handset (in holder)?** Adjustable

**What is the recommended minimum pressure?** 0.5Bar

**What material is the handset made from?** Chrome-plated Brass

## Components

Chrome Plated Concealed Dual Function Valve Body - TRADSVCON2:  
Brass Head; Brass Arm; Brass Wall Elbow; Brass Wall Elbow;  
Brass Handset; Stainless Steel Slider; Concealed Brass Dual Function Valve

Chrome Plated Brass Concealed Valve Flow Handle - TRADSVCONH

Chrome Plated Brass Concealed Valve Temperature Handle - TRADSVCONHT

# Technical Data Sheet

## Henley Shower Systems

# ROPER RHODES®

No.	Description	Code	Fixings Included
1	Henley Triple Function Concealed Diverter Shower System	SVSET146	YES



**FLOW RATE DATA IS TESTED UNDER LABORATORY CONDITIONS: ACTUAL FLOW RATE MAY VARY DEPENDING ON DOMESTIC SUPPLY AND ACCESSORIES**

Inlet Pressure	Flow Rate (l/min)
0.5bar	8.84
1bar	12.12
2bar	17.68
3bar	18.40
4bar	25.00
5bar	27.70

### Dimensions - SVSET146

Diagrams not to scale. All dimensions in mm (tolerance of +/-5mm)

\*Dimensions are subject to change, customers are advised to measure actual product before commencing installation.

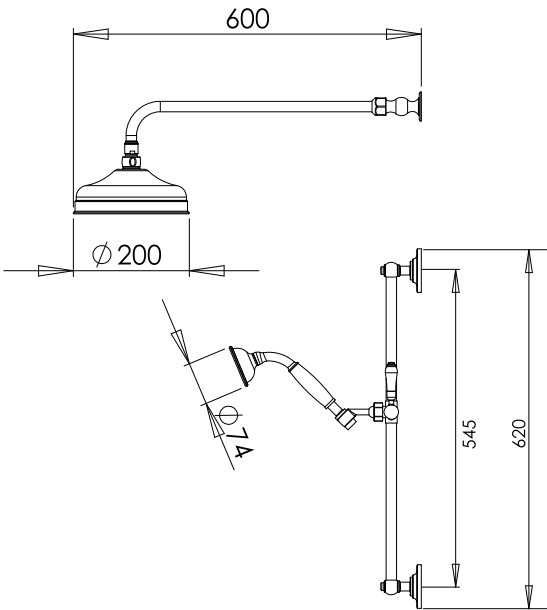
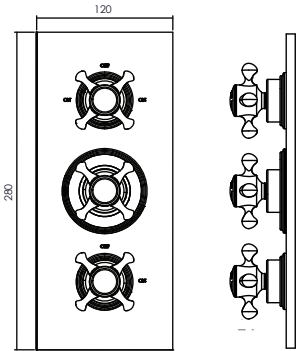

### FAQs

- What is the valve inlet dimension?** 1/2" BSP - 15mm pipework
- What is the valve outlet dimension?** 1/2" BSP threaded outlet
- Can the shower arm and riser rail length be adjusted?** Yes, the shower arm and riser rail can be cut down prior to fitting.
- What is the hose length?** 1.5m
- What is the height of the handset (in holder)?** Adjustable
- What is the recommended minimum pressure?** 0.5Bar
- What material is the handset made from?** Chrome-plated Brass

### Components

Chrome Plated Concealed Triple Function Valve Body - TRADSVCON3;  
 Brass Head; Brass Arm; Brass Wall Elbow; Brass Wall Elbow;  
 Brass Handset; Stainless Steel Slider; Concealed Brass Triple Function Valve

Chrome Plated Brass Concealed Valve Flow Handle - TRADSVCONH  
 Chrome Plated Brass Concealed Valve Temperature Handle - TRADSVCONHT

# Technical Data Sheet

## Henley Shower System

# ROPER RHODES®

No.	Description	Code	Fixings Included
1	Henley Single Function Exposed Shower System	SVSET51	YES

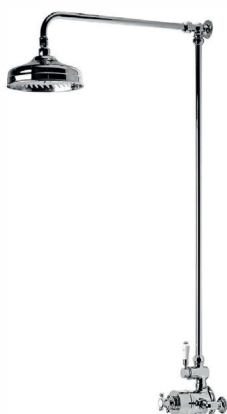

**FLOW RATE DATA IS TESTED UNDER LABORATORY CONDITIONS: ACTUAL FLOW RATE MAY VARY DEPENDING ON DOMESTIC SUPPLY AND ACCESSORIES**

Inlet Pressure	Flow Rate (l/min)
0.3bar	6.74
0.4bar	7.78
0.5bar	8.70
1bar	12.30
2bar	17.39
3bar	18.20

## Dimensions - SVSET51

Diagrams not to scale. All dimensions in mm (tolerance of +/-5mm)

\*Dimensions are subject to change, customers are advised to measure actual product before commencing installation.

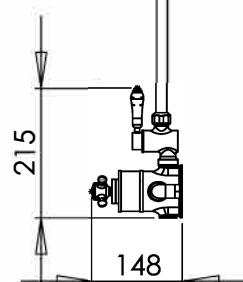
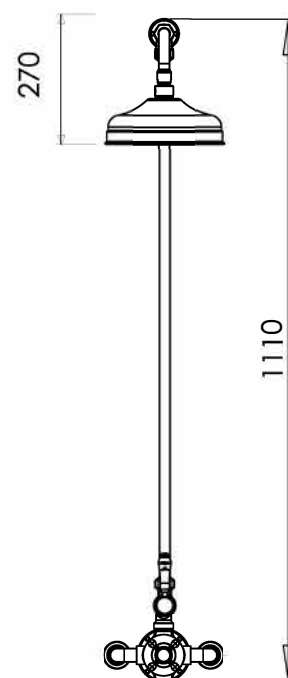
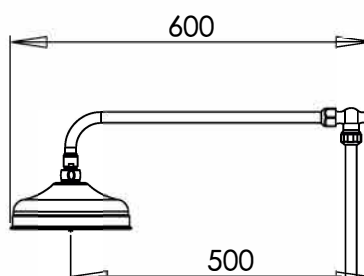
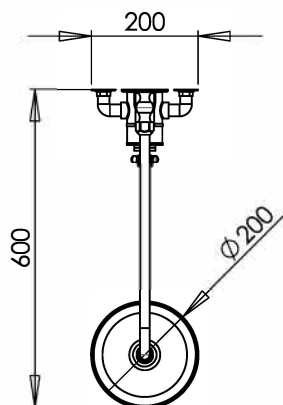

## FAQs

**What is the valve inlet dimension?** 1/2" BSP - 15mm pipework

**Can the shower arm and riser rail length be adjusted?** Yes, the shower arm and riser rail can be cut down prior to fitting.

**What is the hose length?** 1.5m

**What is the diameter of the riser rail?** 18mm

**What is the recommended minimum pressure?** 0.3Bar

**What material is the handset made from?** Chrome-plated Brass

## Components

Chrome Plated Exposed Single Function Valve Body - TRADSVEXP1:  
Brass Head; Brass Arm; Brass Wall Elbow; Stainless Steel Riser Rail; Exposed Brass  
Single Function Valve, Stainless Steel Slider

Chrome Plated Brass Concealed Valve Flow Handle - TRADSVEXPH

# Technical Data Sheet

## Henley Shower Systems

# ROPER RHODES®

No.	Description	Code	Fixings Included
1	Henley Dual Function Exposed Shower System	SVSET50	YES



**FLOW RATE DATA IS TESTED UNDER LABORATORY CONDITIONS: ACTUAL FLOW RATE MAY VARY DEPENDING ON DOMESTIC SUPPLY AND ACCESSORIES**

Inlet Pressure	Flow Rate (l/min)
0.5bar	8.63
1bar	12.20
2bar	17.25
3bar	17.80
4bar	24.40
5bar	27.04

### Dimensions - SVSET50

Diagrams not to scale. All dimensions in mm (tolerance of +/-5mm)

\*Dimensions are subject to change, customers are advised to measure actual product before commencing installation.

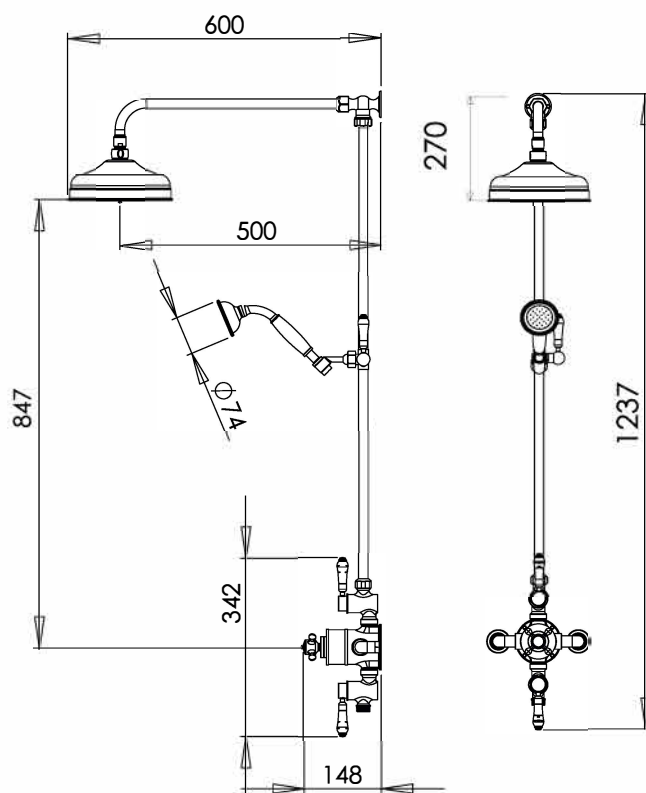
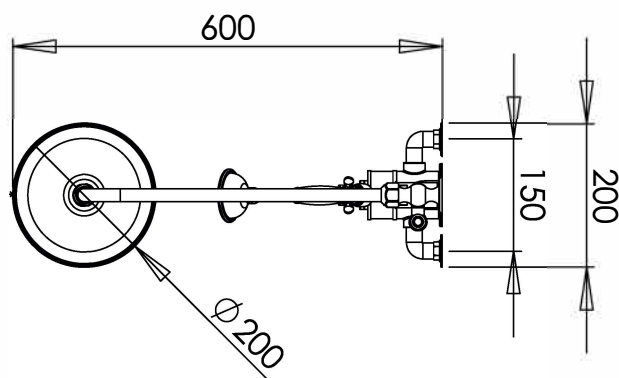

### FAQs

- What is the valve inlet dimension?** 1/2" BSP - 15mm pipework
- Can the shower arm and riser rail length be adjusted?** Yes, the shower arm and riser rail can be cut down prior to fitting.
- What is the hose length?** 1.5m
- What is the height of the handset (in holder)?** Adjustable
- What is the recommended minimum pressure?** 0.5Bar
- What material is the handset made from?** Chrome-plated Brass

### Component

Chrome Plated Exposed Triple Function Valve Body - TRADSVEXP2:  
 Brass Head; Brass Arm; Brass Wall Elbow; Stainless Steel  
 Riser Rail; Brass Handset; Stainless Steel Slider; Exposed Brass 2F Valve  
 Chrome Plated Brass Concealed Valve Flow Handle - TRADSVEXPH