

LEVITATE

LED Illuminated Mirror

Installation & Aftercare Instructions

Retain for future reference

Customer Services, Brassmill Lane Trading Estate, Bath BA1 3JF.
Tel 01225 303 900 | www.r2bathrooms.co.uk

Electrical Safety

Suitable for UK Installations only.

All fittings must be installed by a competent person, in accordance with current IEE wiring regulations. If in doubt consult a qualified electrician.

Important: Always switch off the electrical supply at the mains before installation and maintenance. It is recommended that the fuse is withdrawn or the circuit breaker is switched off for the necessary circuit before installation commences.

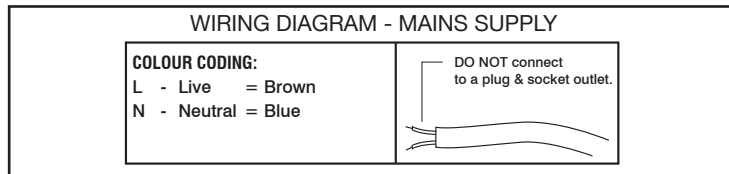

Bathroom Zones

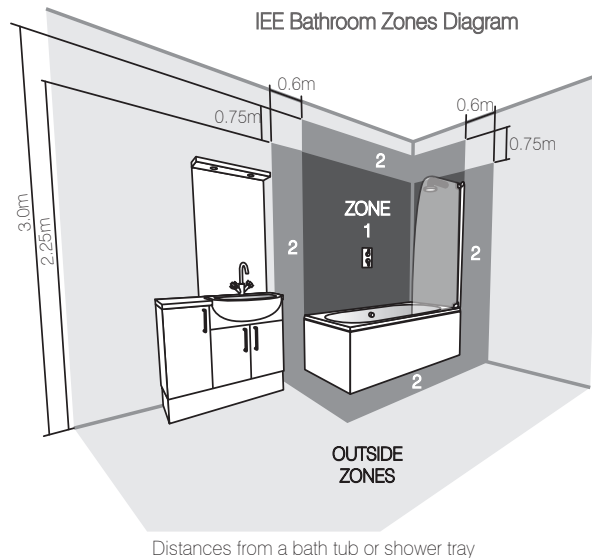

Bathroom fittings are subject to the appropriate zones in accordance with IEE Regulations. This product is only suitable for permanent indoor installation in Zone 2 and outside zones. (See above) This product is not suitable for installation in Zone 0 or 1, saunas, steam rooms or shower cubicles. Do not connect to a trailing plug and socket. Do not install onto surfaces that are either damp or electrically conductive.

After Care Service

Cleaning your product

When cleaning the mirror or any mirrored surfaces it is recommended to use a soft, dry, non abrasive cloth with the mirror turned off. Do not use cleaning agents or abrasive materials.

Do not allow moisture to come into contact with any electrical components.

Troubleshooting & After care service

For any further assistance, please contact our tech support team at: 01225 303 900.

We reserve the right to amend the specification of its products at any time if an opportunity to improve the product occurs. All dimensions are approximate and are quoted within reasonable tolerances.

Compliance

This product complies with all relevant British and European safety standards. For energy class of your product, please refer to the safety label on this product. (EU) 2019/2020 and (EU) 2019/2015



Operating Instructions

Your mirror comes with LED lighting that can change colour and brightness. The mirror also has a steam-free feature in the centre of the mirror. There are two **touch buttons**.

Light control touch button



Steam-free touch button



Turn steam-free ON/OFF

1. Single tap the steam-free button which will become red when on.

Note: After 60 minutes of no operation it will automatically switch off.

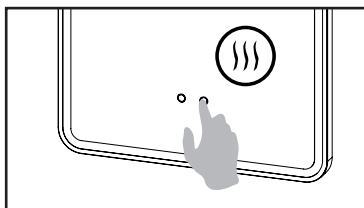

Turn lighting ON/OFF

1. Single tap the light button.

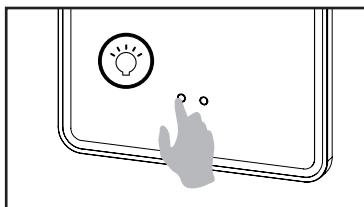

Change lighting colour

1. Double tap to adjust between the 3 colours - Warm, Natural and Daylight.

Note: The colour will be memorised.

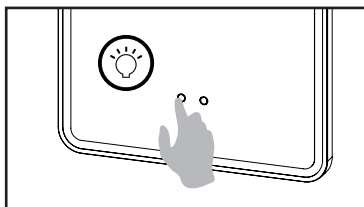

Change LED lighting brightness

1. Press and hold to adjust its brightness.
2. Release once desired brightness is reached or press again to do the opposite brightness.

Note: The brightness will be memorised.

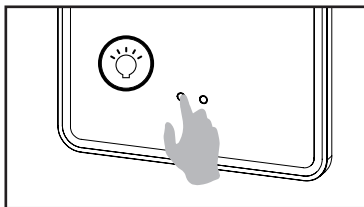

BLANK

Installation Procedure

Important: Before starting the installation process, make sure the electrical supply is switched off. It is recommended that the fuse is withdrawn or the circuit breaker is switched off for the necessary circuit.

Important: Before starting the installation process, ensure the wall construction is suitable and can support the weight of the mirror.

Note: The wall plugs supplied are suitable for solid stone / brick walls. For any other wall material use specialist wall plugs.

- 1) Measure the distance (X) between the keyhole slots on the back of the mirror.
- 2) Mark out the fixing screw positions on the wall using a pencil to the desired height, ensuring they are spaced at distance (X).

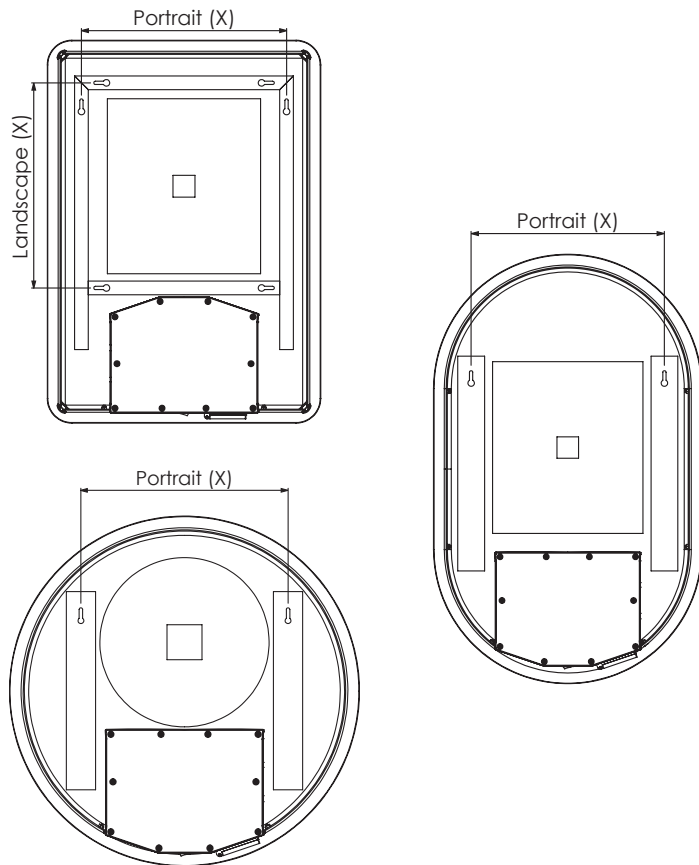

Installation Procedure

3) Drill the marked out positions and fit the wall plugs accordingly. Fix the screw into position, leaving a small amount of the screw head proud of the wall for hanging.

4) Make the electrical connection from the mirror to the mains supply. Use the connection wire found at the rear of the mirror to make the necessary connections in accordance with the current IEE regulations. A second person will need to hold the mirror in place whilst electrical connections are made.

5) The mirror should easily slide onto the fixing screws and secure into place.

NOTE: To secure the mirror further, a small amount of silicone sealant can be applied to the side of the extrusions to prevent the mirror being accidentally pulled away from the wall.

To remove the mirror, the mirror should first be lifted and then pulled away from the wall.

