

Wall Mounted Bath Filler

Installation & Aftercare Instructions

Please retain for future reference

The images used in this instruction guide are for illustrative purposes and may not be an exact match to the product you have purchased. The instruction steps are identical for all product variants.

BEFORE YOU START

NOTE: Most problems associated with the operation of valves are caused by debris in the new pipe work getting into the cartridge. These problems are easily avoided by thoroughly flushing the pipe work BEFORE the valve is fitted. We recommend this product is fitted by a professional plumber.

This wall mounted bath filler is intended to be installed on a solid brick wall. Before installation, take into account the finished wall thickness of any plasterboard / tiles in order to recess the wall mounted bath filler valve to make all connections and allow all components to be assembled correctly.

The minimum and maximum cavity depths are shown in the diagram below but should be checked before installing the final wall surface.

KEY DIMENSIONS

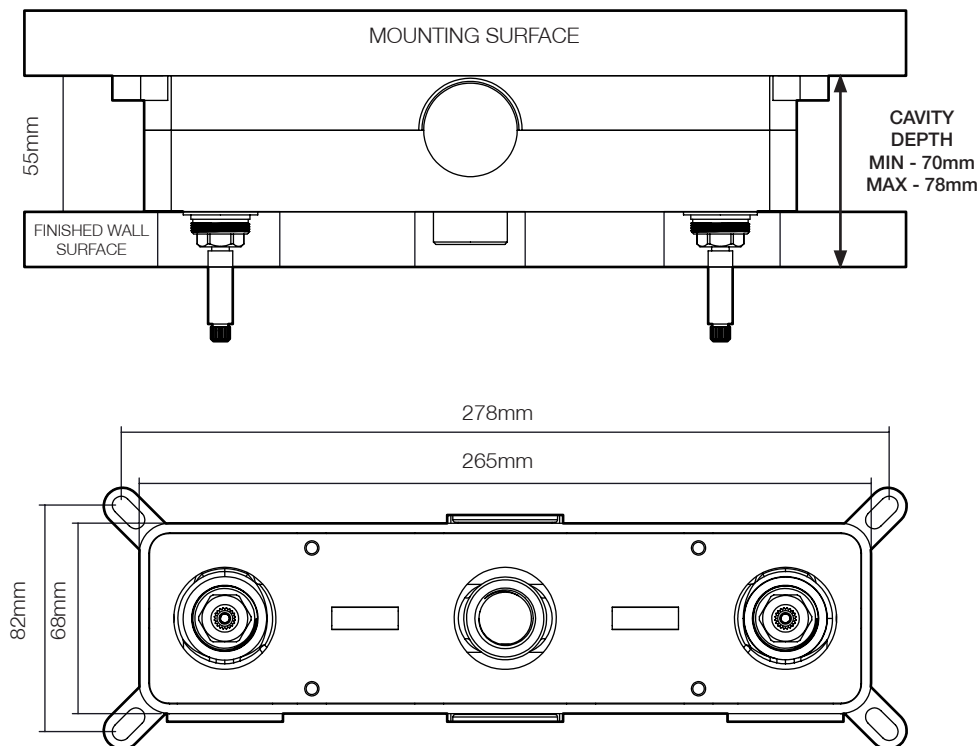

INSTALLATION - MOUNTING THE VALVE BOX

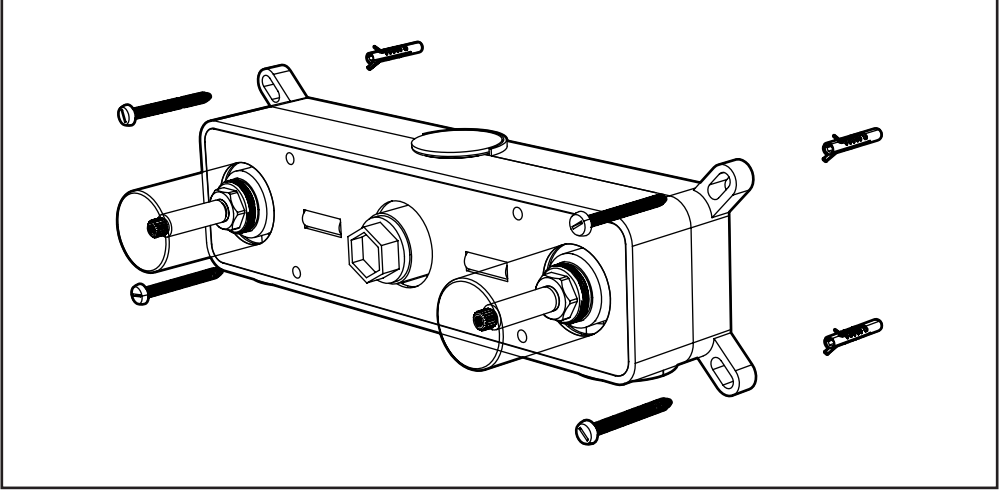

1. Before starting installation, turn the water supply off. Determine the position of the bath filler valve and ensure that when the final finished wall surface is installed, the valve is recessed enough to assemble correctly. Mark the fixing tab locations on the mounting surface and drill suitable sized holes for the fixings supplied.

Use the spirit levels on the installation box to ensure the box is level.

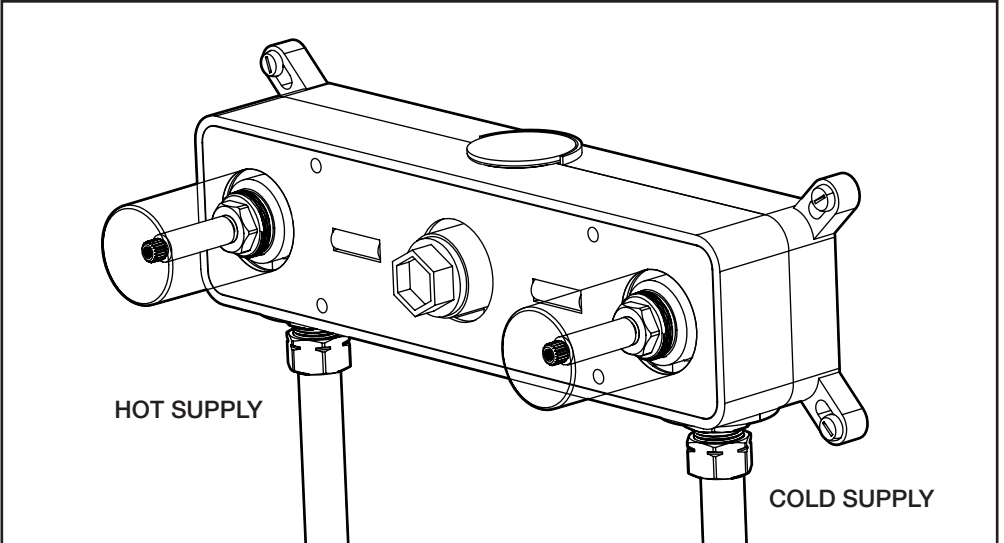

2. With the valve mounted, make the plumbing connections. The hot supply should be connected to the left hand inlet on the valve box, marked HOT. Both inlet connections are 1/2" BSP threaded and suitable for parallel plumbing fittings. Ensure that there are isolation points on both supplies so that maintenance and component replacement can be undertaken later.

Turn the water supply back on and check for any leaks on the supply inlets.

INSTALLATION - APPLYING FINISHED WALL SURFACE

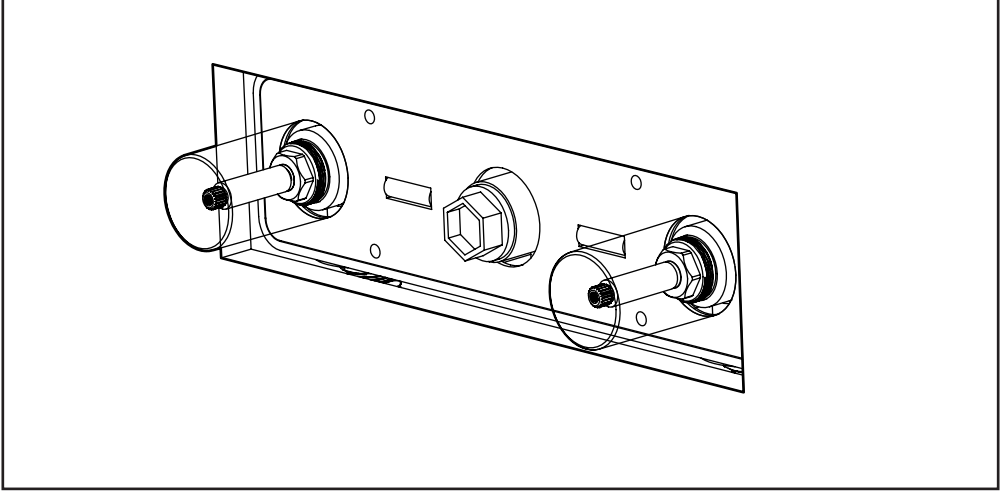

3. With the inlets checked, turn the water supply back off and prepare your finished wall surface. If using plasterboard in your installation, the valve box should be slightly recessed to allow for tiles to be applied over the top of the box.

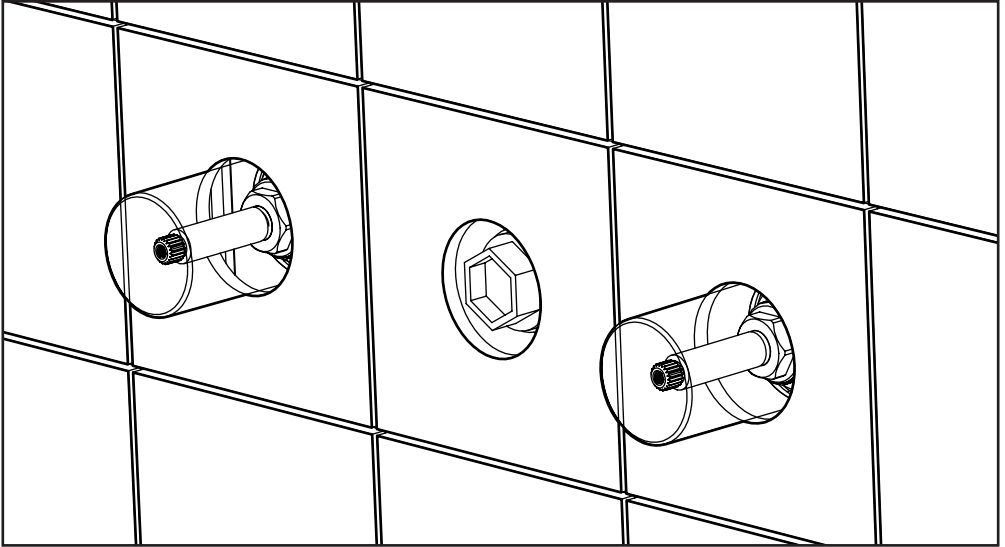

4. If tiling your finished wall surface, cut appropriate sized holes in the tile to install them over the protective covers pre-installed onto the valve. This will allow enough room for the handle trims to be assembled, as well as enough room for a socket wrench to remove the hot and cold valves for maintenance.

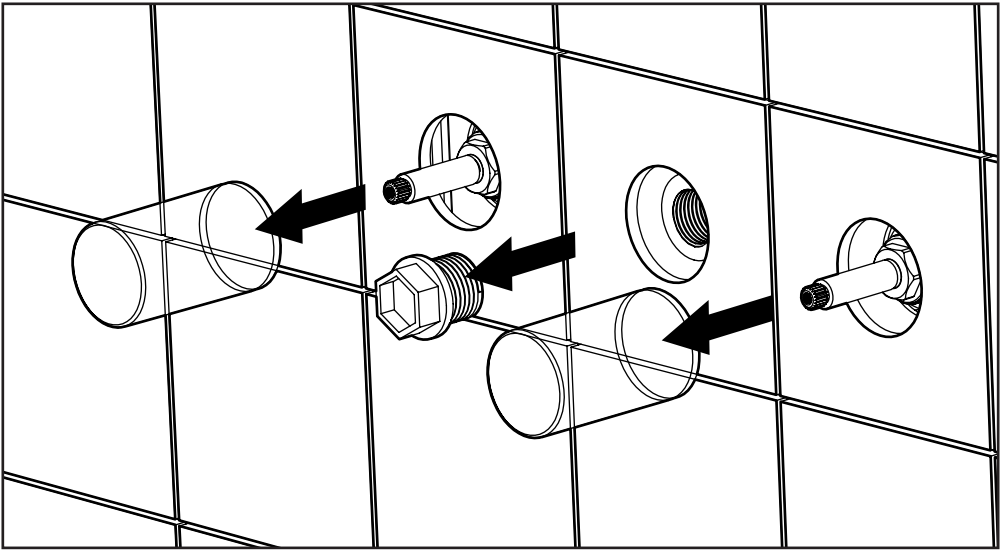

5. With the tiling complete, remove the spout blanking plug and two protective valve covers. These are no longer needed and can be recycled.

The hot and cold valves and threaded spout outlet will now be accessible.

INSTALLATION - HANDLES AND SPOUT

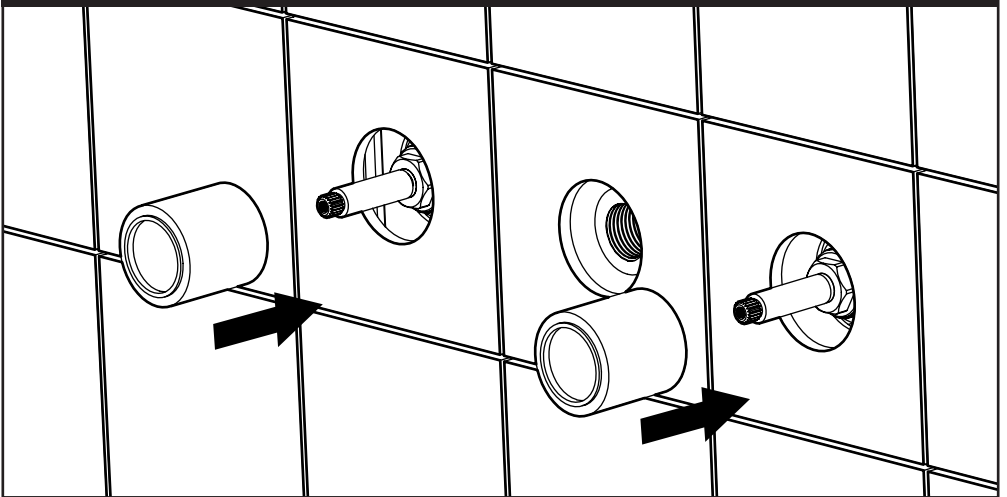

6. Thread the valve trims onto each of the valves. Tighten until secure.

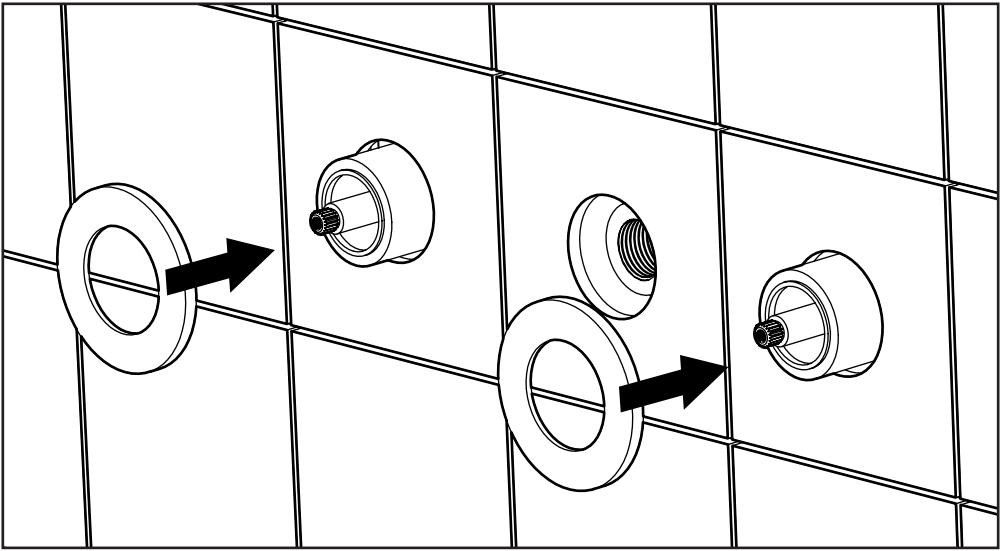

7. With the valve trims installed, you can now install the handle cover plates. These will be large enough to cover the access hole in the finished wall surface.

Apply a small bead of silicone to each cover plate to secure it to the finished wall surface.

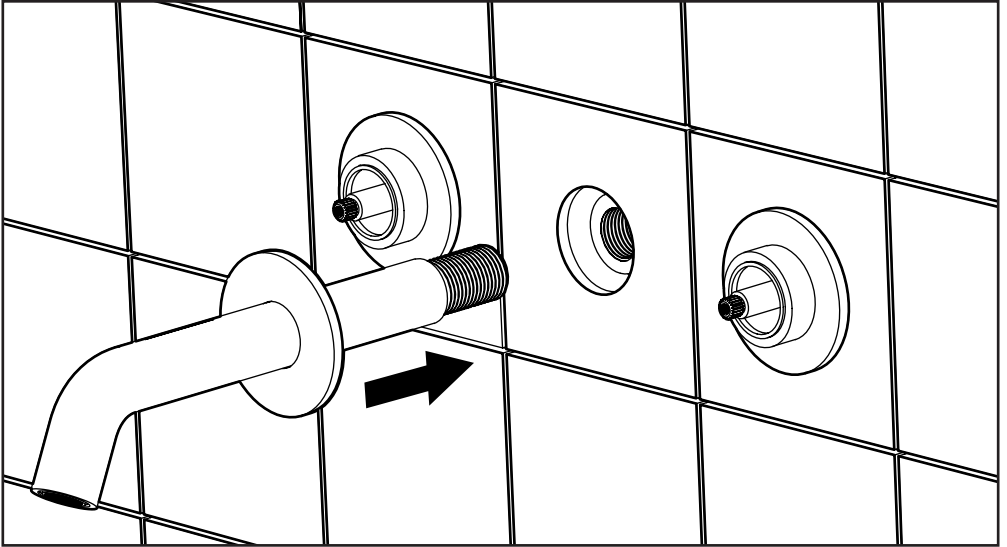

8. The spout and cover plate can now be installed. Slide the coverplate onto the spout and screw the spout into the outlet on the installation box. PTFE tape can be used to ensure a watertight seal and allow some rotational adjustment to the spout.

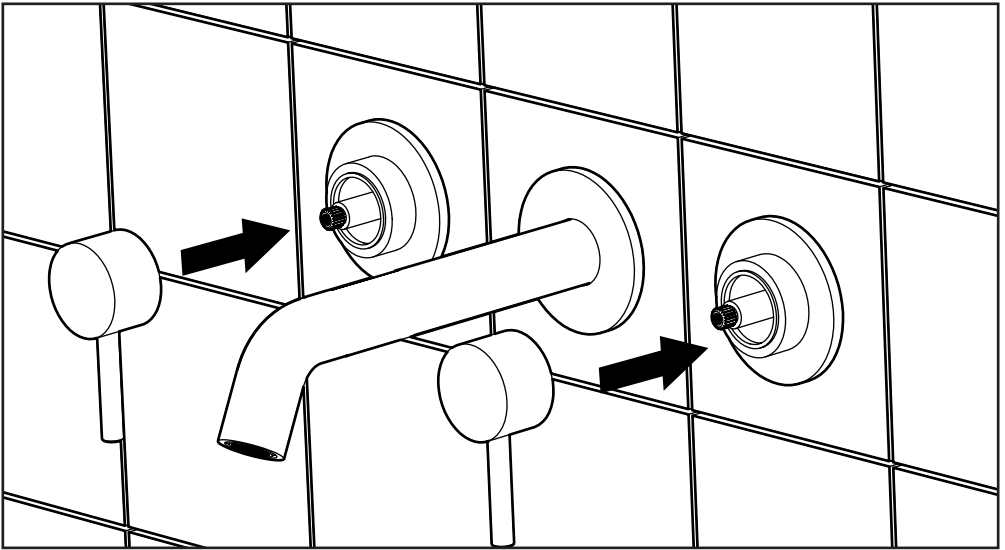

9. The handles can now be installed. Unscrew the rod on the handle to allow access to the grub screw and secure to each valve - ensuring that the handle is in the correct position for your desired installation. The hot handle will rotate clockwise and the cold handle will rotate anti-clockwise. Screw the rod back onto the grub screw.

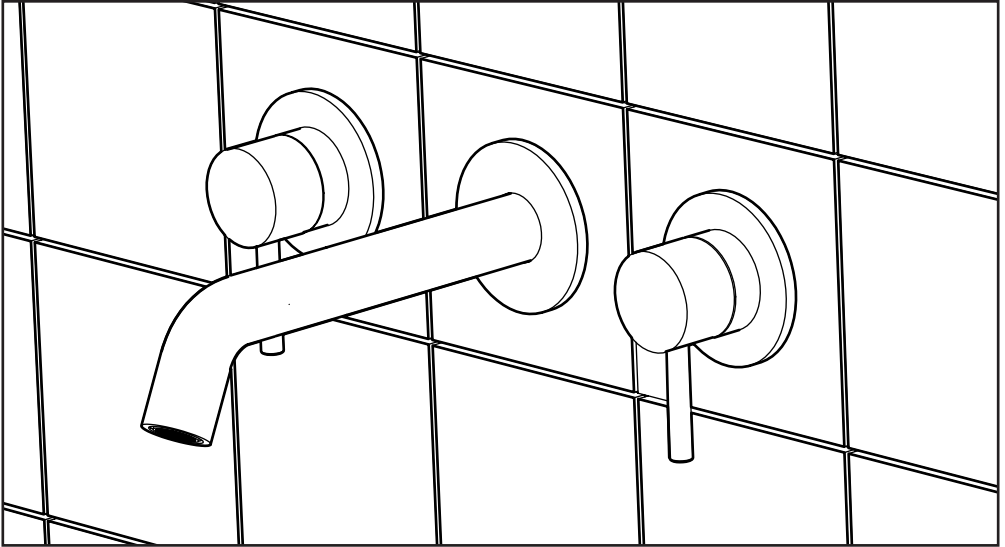

10. Turn the water supply back on and run water through both the hot and cold valves. Check that the handles rotate correctly and re-align if necessary.

Installation is now complete.

AFTERCARE INSTRUCTIONS

We have complete confidence in this product and as such it is offered with a 10-year guarantee against defects in manufacture. This product must be fitted by a competent installer. If in doubt, seek advice from a qualified professional.

The guarantee requires that this product be used in the manner for which it was intended and that it is installed & maintained in accordance with the fitting instructions and local water bylaws. The guarantee is invalidated should the product be damaged by water borne debris. Make sure that supply pipes are clear of any debris prior to installation; this is particularly important on new plumbing installations.

In the unlikely event that this product should fail during the guarantee period we will either replace the faulty part or the complete unit as appropriate. This guarantee covers damage against reasonable wear and tear in use only. It does not cover damage incurred during installation, misuse or inappropriate maintenance.

Failure to follow the terms outlined above will invalidate this guarantee. Proof of purchase will be required.

Replacement parts are available to purchase by contacting the customer service team using the contact details below.