

# Wall Mounted Bath Shower Mixer

## Installation & Aftercare Instructions

Please retain for future reference

The images used in this instruction guide are for illustrative purposes and may not be an exact match to the product you have purchased. The instruction steps are identical for all product variants.

### BEFORE YOU START

NOTE: Most problems associated with the operation of valves are caused by debris in the new pipe work getting into the valves. These problems are easily avoided by thoroughly flushing the pipe work BEFORE the valve is fitted. We recommend this product is fitted by a professional plumber.

This wall mounted bath shower mixer is intended to be installed on a solid brick wall. Before installation, take into account the finished wall thickness (including plasterboard and tiles) as well as your desired pipework route, in order to recess the wall mounted bath shower mixer valve enough to make all connections and allow all components to be assembled correctly.

The minimum and maximum cavity depths are shown in the diagram below but should be checked before installing the final wall surface.

### KEY DIMENSIONS

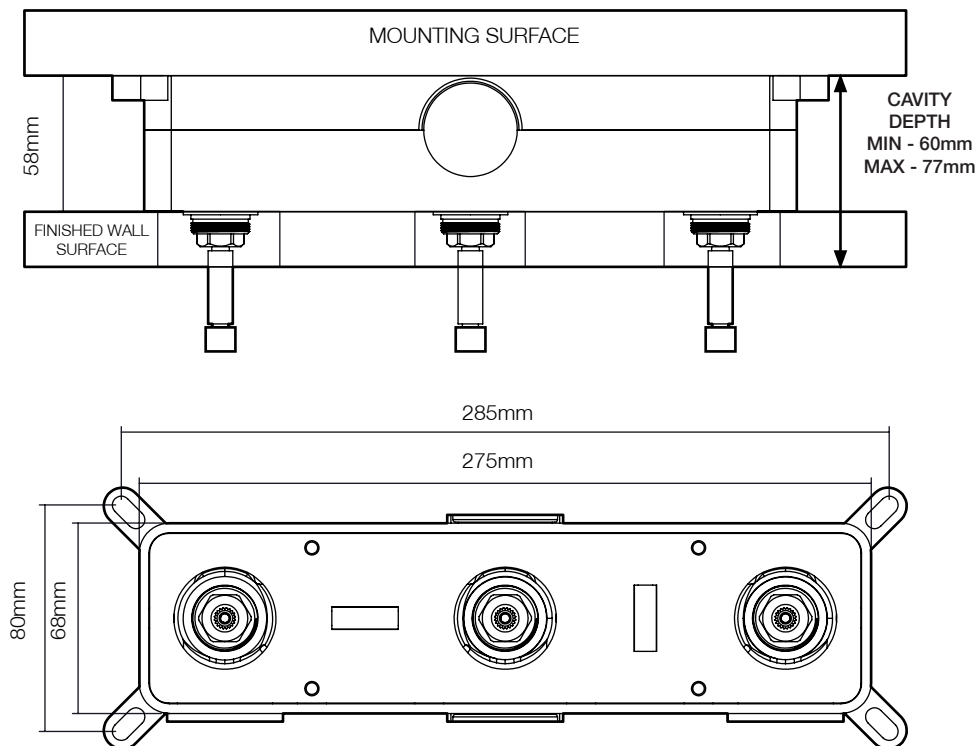

## INSTALLATION - MOUNTING THE VALVE BOX

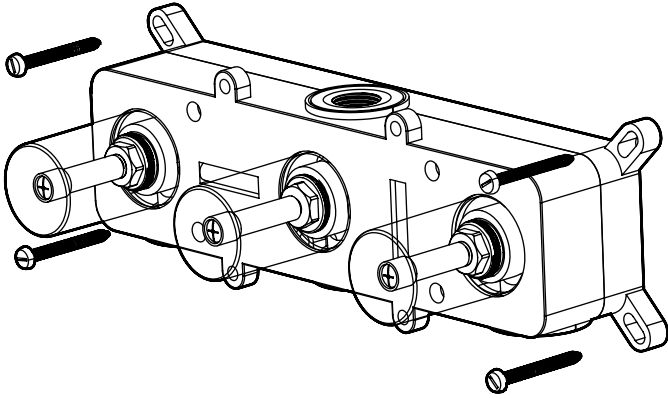

1. Before starting installation, turn the water supply off. Determine the position of the bath shower mixer valve and ensure that when the final finished wall surface is installed, the valve is recessed enough to assemble correctly. Mark the fixing tab locations on the mounting surface and drill suitable sized holes for the fixings supplied.

Use the spirit levels on the installation box to ensure the box is level.

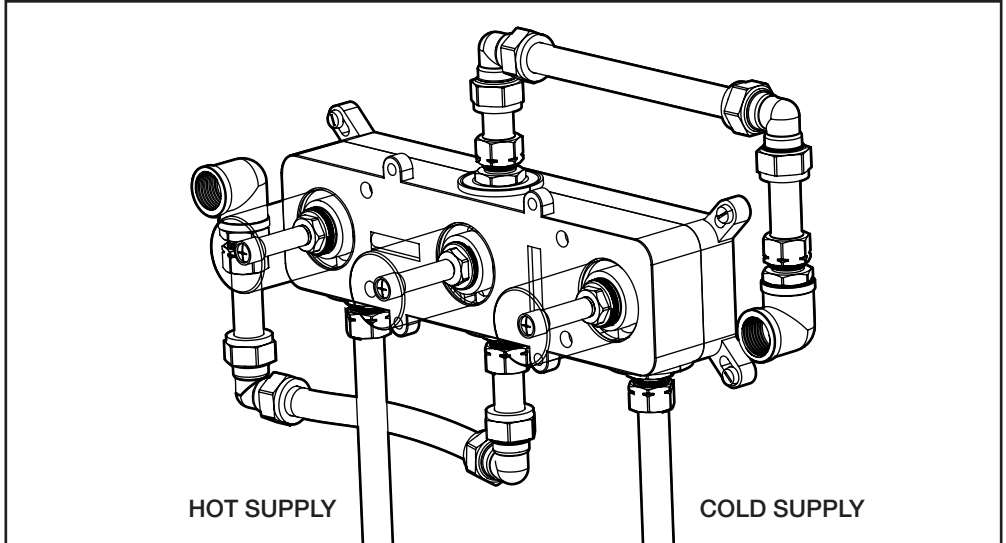

2. Make your plumbing connections. The hot supply should be connected to the left hand inlet on the valve box. Both inlet and outlet connections are 1/2" threaded and suitable for parallel plumbing fittings. Ensure that there are isolation points on both supplies so that maintenance and component replacement can be undertaken later. Both the spout and handset outlet provided use 1/2" threads so suitable elbow connections for the spout and handset outlet need to be used. Turn the water supply back on and check for any leaks on all connections.

## INSTALLATION - APPLYING FINISHED WALL SURFACE

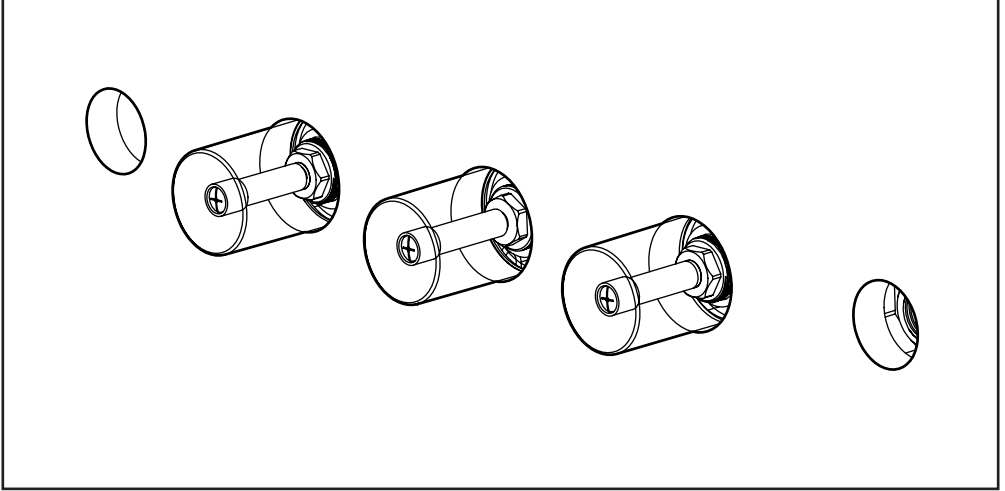

3. With the inlets and outlets checked, turn the water supply back off and prepare your finished wall surface. The plastic covers supplied with the box will be removed after the finished wall surface is in place, so ensure the holes are 50mm in diameter to allow enough clearance for their removal.

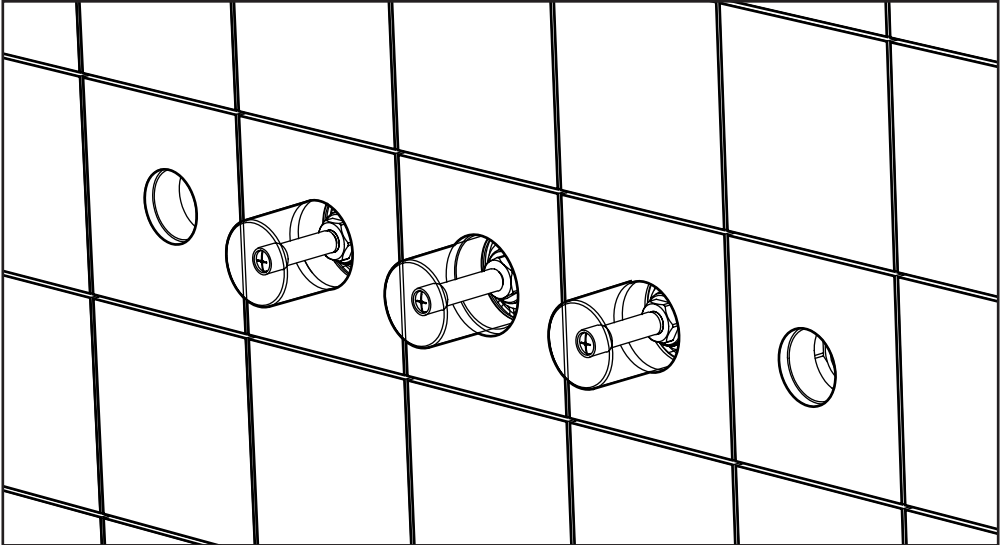

4. If tiling your finished wall surface, cut 50mm holes in the tile to install them over the protective covers. This will allow enough room for the handle trims to be assembled, as well as enough room for a socket wrench to remove valves for maintenance or replacement.

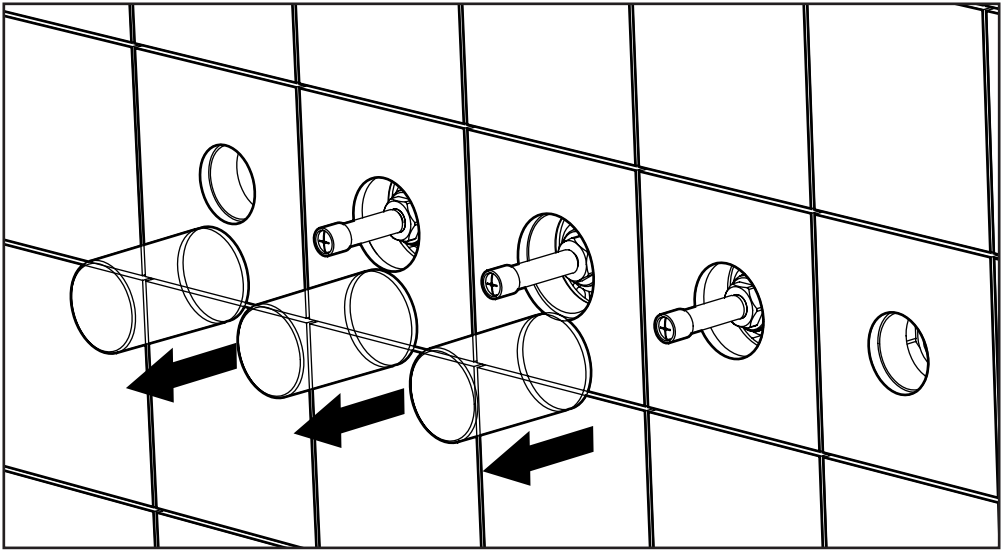

5. With the tiling complete, remove the protective valve covers. These are no longer needed and can be recycled.

The hot and cold valves and central diverter valve will now be accessible.

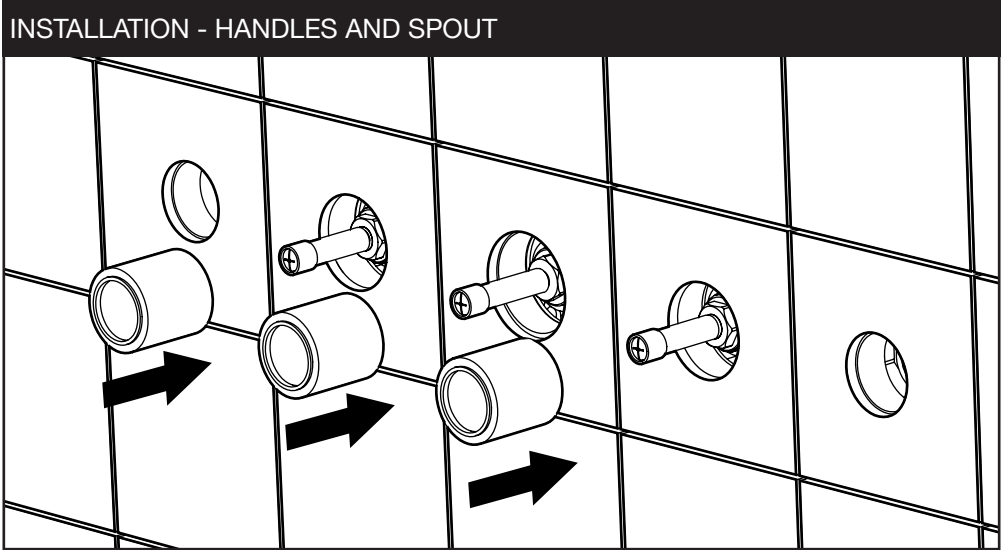

6. Thread the valve trims onto each of the valves. Tighten until secure.

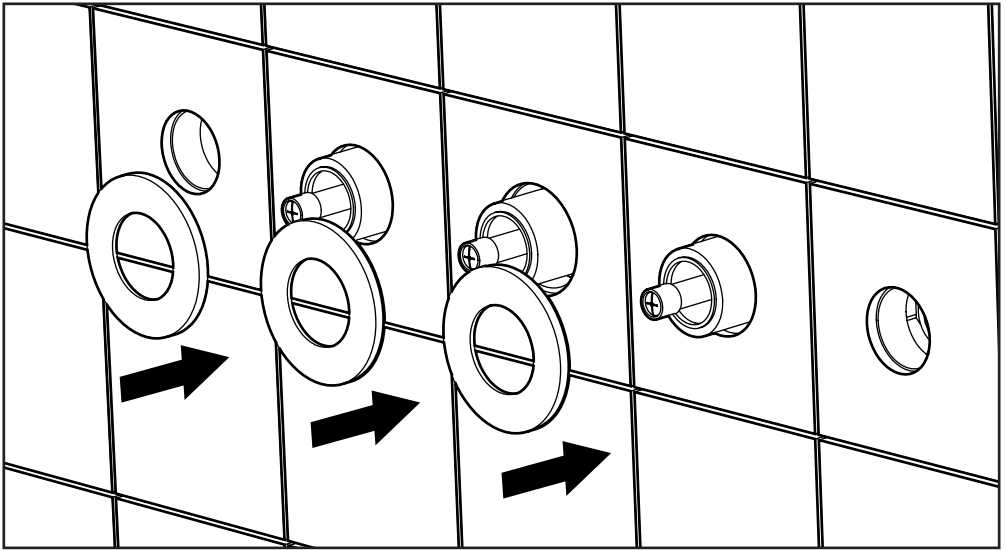

7. With the valve trims installed, you can now install the handle cover plates. These will be large enough to cover the access hole in the finished wall surface. There is an etched coverplate which needs to be used on the central handle which controls the diverter valve.

Apply a small bead of silicone to each cover plate to secure it to the finished wall surface.

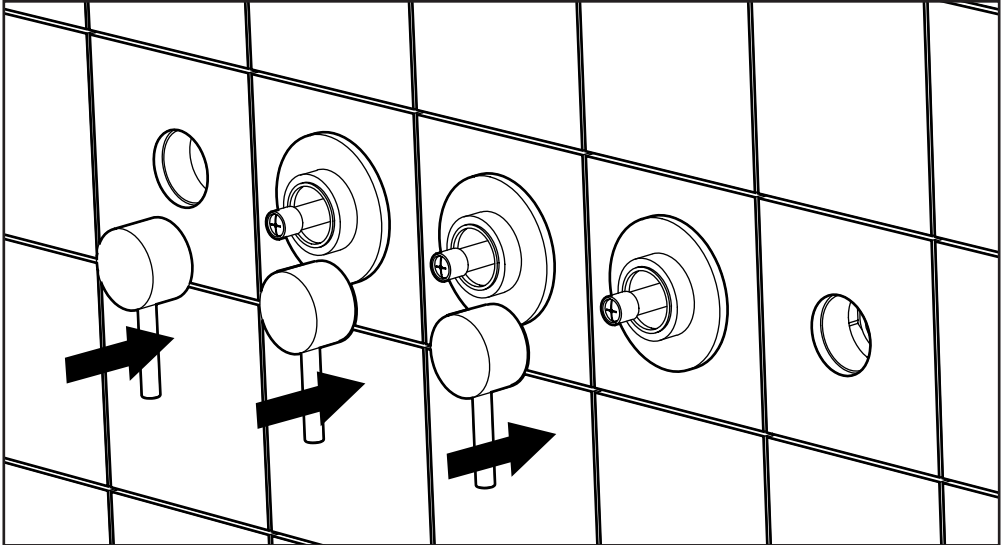

8. The handles can now be installed. Unscrew the rod on the handles to allow access to the grub screw and secure to each valve - ensuring that the handle is in the correct position for your desired installation. The hot handle will rotate clockwise and the cold handle and diverter handle will rotate anti-clockwise. Screw the rod back onto the grub screw.

The positions of the handles can be adjusted later if necessary.

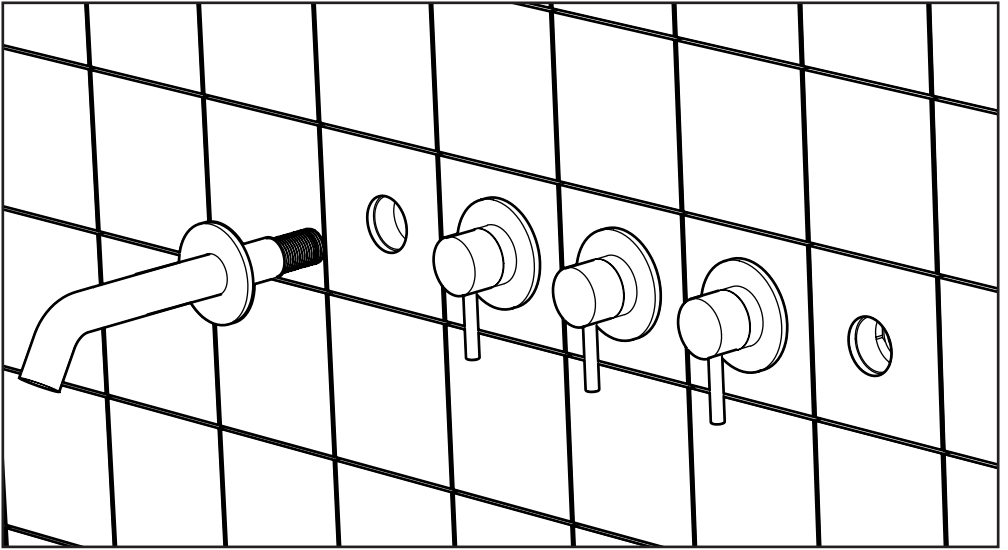

9. The spout and cover plate can now be installed. Slide the coverplate onto the spout and screw the spout into the 1/2" threaded plumbing fitting installed earlier. PTFE tape can be used to ensure a watertight seal and allow some rotational adjustment to the spout.

Apply a small bead of silicone to the cover plate to secure it to the finished wall surface.

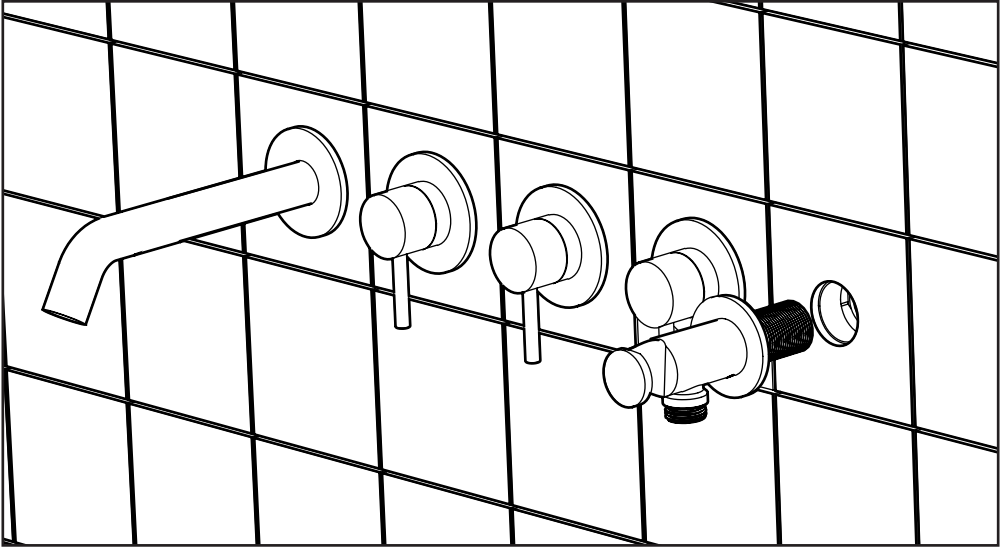

10. The handset outlet can now be installed. The handset outlet can be screwed into the 1/2" threaded plumbing fitting behind the finished wall surface. PTFE tape can be used to ensure a watertight seal.

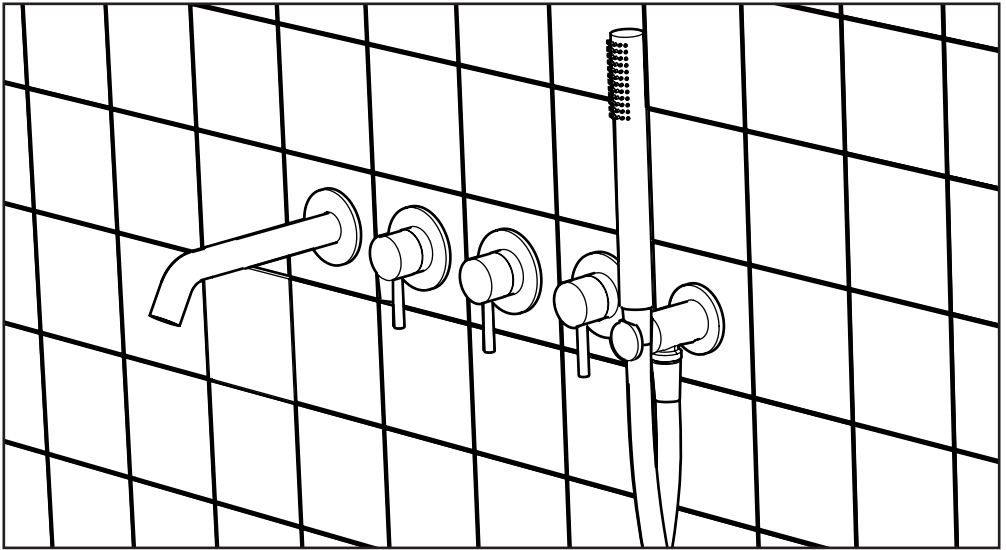

11. With the handset outlet now secured in place the shower hose and handset can be installed. Turn the water supply back on and run water through both the hot and cold valves as well as testing the diverter valve by running water through both outlets.

Installation is now complete.

## AFTERCARE INSTRUCTIONS

We have complete confidence in this product and as such it is offered with a 10-year guarantee against defects in manufacture. This product must be fitted by a competent installer. If in doubt, seek advice from a qualified professional.

The guarantee requires that this product be used in the manner for which it was intended and that it is installed & maintained in accordance with the fitting instructions and local water bylaws. The guarantee is invalidated should the product be damaged by water borne debris. Make sure that supply pipes are clear of any debris prior to installation; this is particularly important on new plumbing installations.

In the unlikely event that this product should fail during the guarantee period we will either replace the faulty part or the complete unit as appropriate. This guarantee covers damage against reasonable wear and tear in use only. It does not cover damage incurred during installation, misuse or inappropriate maintenance.

Failure to follow the terms outlined above will invalidate this guarantee. Proof of purchase will be required.

Replacement parts are available to purchase by contacting the customer service team using the contact details below.