

# Technical Data Sheet

## PLATFORM 500mm Wall Mounted Unit

Whats in the box: 1x PLT5012.X + Fixings

# R2

\*Reference basin TDS for further info

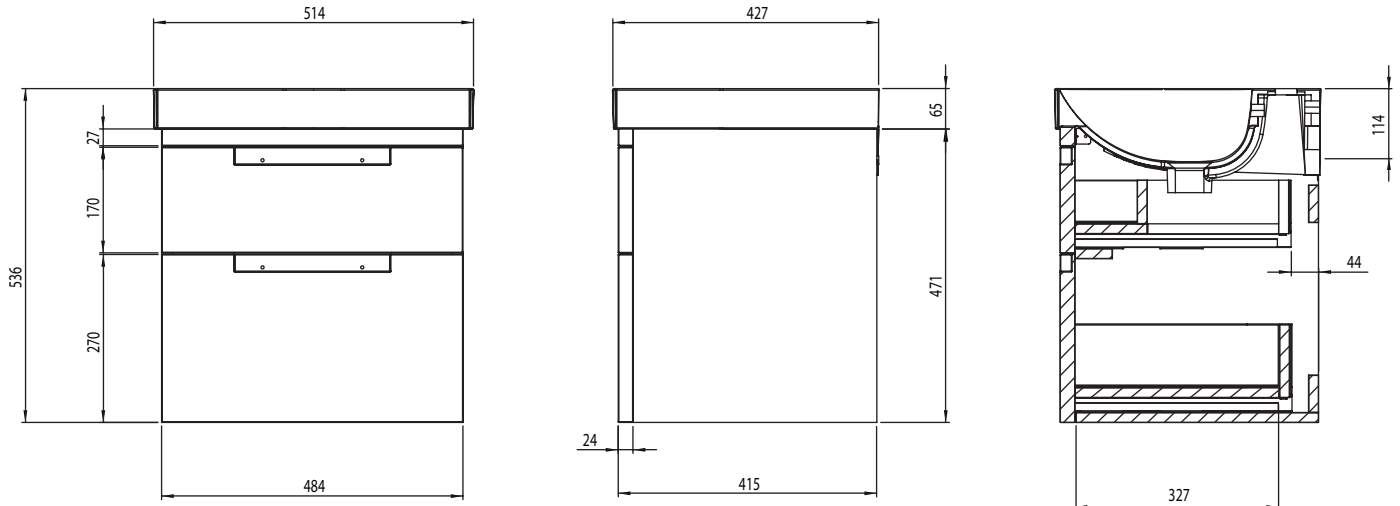

Diagrams not to scale  
All dimensions in mm  
tolerance of +/-5mm

### Materials

Carcass: 18mm MDF & 16mm MFC

Fascia Components: 24mm Painted MDF

\*\*Dimensions are subject to change, customers are advised to measure actual product before commencing installation.

\*\*\*Fixing point dimensions are for guidance only/the positions of wall fixing must be checked when product is received.

### Extra Dimensions

Internal Drawer Depth - Front to Back:	327mm
Internal Drawer Height:	70
Internal Drawer Width:	406mm
Drawer Cut Out (W&D):	204mm x 243mm

### FAQs

Q: How big is the plumbing void at the back of the furniture?	A: 44mm
Q: Are the handles fitted?	A: No, handles need fitting.
Q: Are the runners soft close?	A: The runners are both soft close and quick release.
Q: How deep is the unit when the drawers are fully open?	A: Approx. 780mm including handle.
Q: Can the drawers be adjusted?	A: They can be adjusted as detailed in the supplied instructions.
Q: What is the interior finish of the unit?	A: Dark Grey on all units.

NOTE: Colours unique to Roper Rhodes - No RAL Code available