

# Technical Data Sheet

## 400mm Single Door Cabinet - AM4051

Whats in the box: 1x Cabinet + Fixings + 2 Wood Shelves

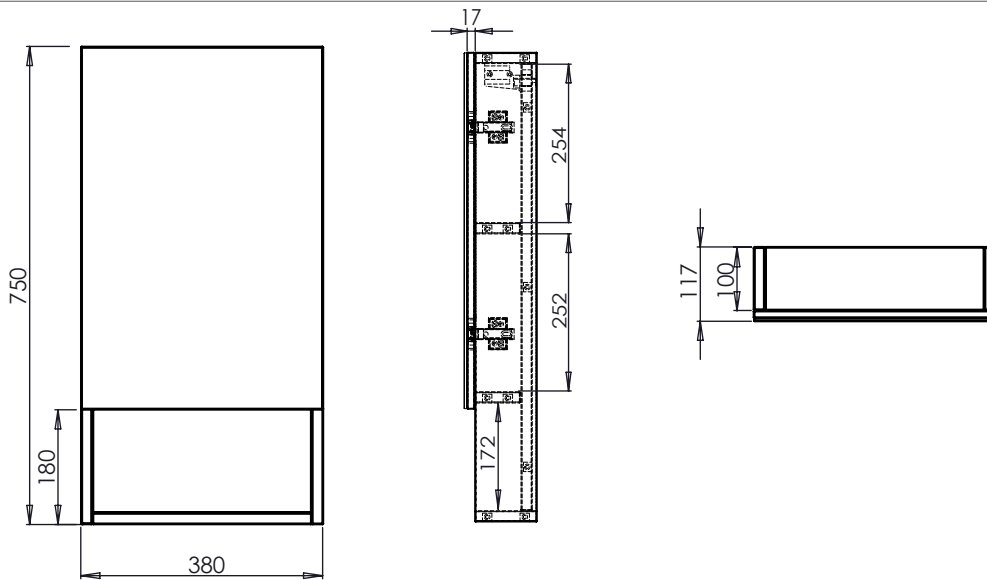

### Materials

Carcass: Painted MDF

Door: MDF

Mirror: Bevelled Glass Mirror

\*Dimensions are subject to change, customers are advised to measure actual product before commencing installation.

\*\*Fixing point dimensions are for guidance only/the positions of wall fixing must be checked when product is received.

Diagrams not to scale. All dimensions in mm (tolerance of +/-5mm)

### FAQ's

- |  |                       |
|--|-----------------------|
| Q: Internal dimensions (Width x Depth).            | A: 350 x 73mm         |
| Q: Shelf dimensions ( Length x Width x Depth).     | A: 350 x 73 x 15mm    |
| Q: Max shelf spacing.                              | A: 254mm              |
| Q: Distance between hinge centres.                 | A: 350mm              |
| Q: Door dimensions (Height x Width x Depth).       | A: 550 x 380 x 17mm   |
| Q: Door opening angle.                             | A: 90°                |
| Q: Depth with door fully open.                     | A: 453mm              |
| Q: Hanging brackets centres.                       | A: 334mm              |
| Q: What is the thickness of the cabinet door glass | A: 5mm (On 12mm MDF). |

Cabinets with painted finish do not have a RAL code as the colour is unique to R2.