

TECHNICAL DATA SHEET

ARUBA SCT Slim Depth Basin - AR2SCBAS

ROPER RHODES®

NO.	Description	Product Code	Template included	Gross Weight
I	Semi Recess Basin - Slim Depth	AR2SCBAS	YES	12KG



DIMENSIONS

DIAGRAMS NOT TO SCALE | ALL DIMENSIONS IN MM TOLERANCE OF ± 5 MM
ALL PRODUCTS CONFORM TO BRITISH STANDARDS

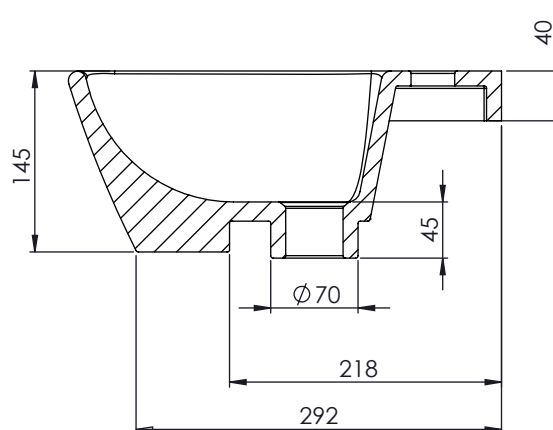
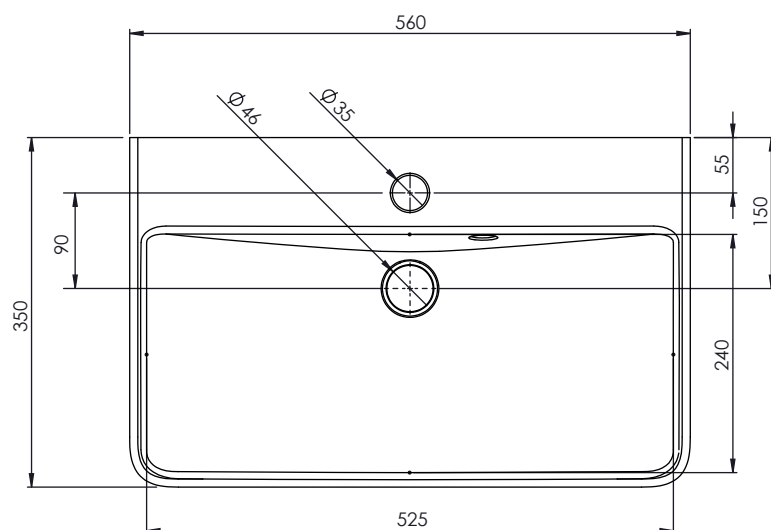

*Dimensions are subject to change, customers are advised to measure actual product before commencing installation.
**Fixing point dimensions are for guidance only. The positions of fixings must be checked when product is received.

FAQs

Q: What is the maximum water depth of the basin?

A: 110mm up to the overflow.

Q: What is the width and length of the Basin Belly?

A: 525mm wide and projects 132mm from the worktop.

Q: What is the depth of the Tapledge?

A: The Tapledge is 100mm deep.

Q: Can you cut the worktop at either end of the bowl?

A: Yes, worktop can be cut to suit installation requirement with or without design and filler panels.

Q: What are the taphole/ basin waste sizes?

A: All sizes are to British Standard - (BS EN 31)

Diameter of the central tap hole = 35mm: $\pm 2/-1$ mm

Bore of the waste outlet hole = 46mm: $\pm 2/-3$ mm

Diameter of the base for the seal between the waste outlet hole and the waste fitting = ≥ 60 mm

Q: What finish is the ceramic glaze?

A: Keramik White