

TECHNICAL DATA SHEET

Faber Wrap Over Toilet Seat

ROPER RHODES®

NO.	Description	Product Code	Fixings included	Gross Weight
I	Soft Close Wrap Over Toilet Seat	DCI4077-SF	YES	2.7KG



DIMENSIONS

DIAGRAMS NOT TO SCALE | ALL DIMENSIONS IN MM TOLERANCE OF ± 5MM  
ALL PRODUCTS CONFORM TO BRITISH STANDARDS

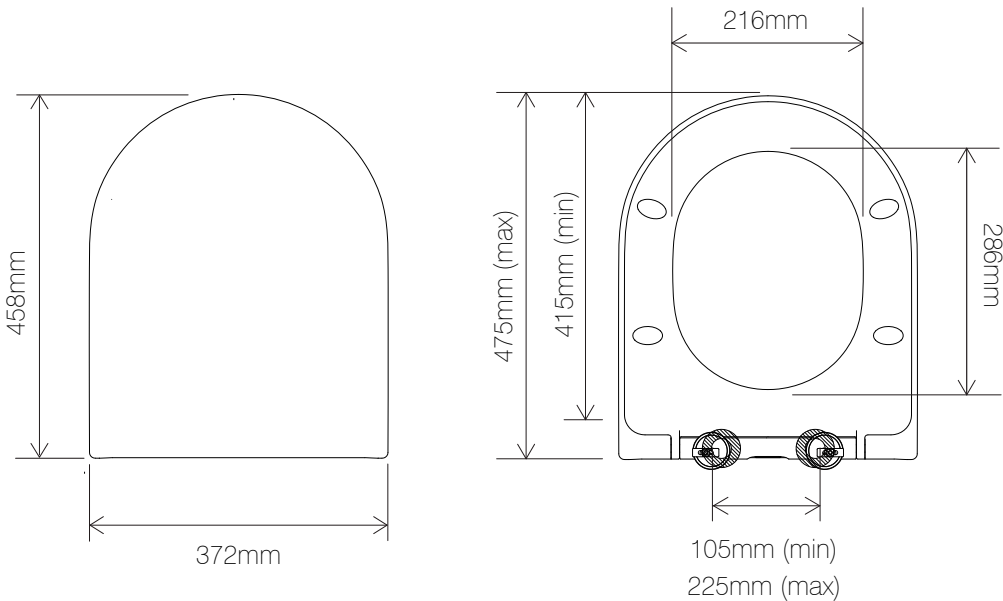

\*Dimensions are subject to change, customers are advised to measure actual product before commencing installation.

FAQs

- Q - What's the maximum test load of the seat?

A - 150kg
- Q - What are the fixings made from?

A - Stainless Steel Cover Plates/Screws, Nylon Anchor Plates, Rubber Washers, Rubber Fixing Plugs.
- Q - What finish are the hinge covers supplied with the seat?

A - Chrome
- Q - Can the seat hinges be upgraded to a different finish?

A - Yes using DC4032 (black), DC4033 (brushed brass) or DC4034 (gunmetal), DC4046 (brushed bronze), Brushed Nickel?
- Q - What colour finish is the seat?

A - Alpine White

Key Dimensions Descriptions	Key Dimensions (mm)
Seat/Lid Front to Back	458mm
Seat/Lid Left to Right	372mm
Ring Hole Front to Back	286mm
Ring Hole Left to Right	216mm
Seat Overall Thickness	38mm
Width of Back of Seat	372mm