

Technical Data Sheet

STATUS 600mm 2 DOOR UNIT

What's in the box: 1x STA6010.X + Fixings

R2

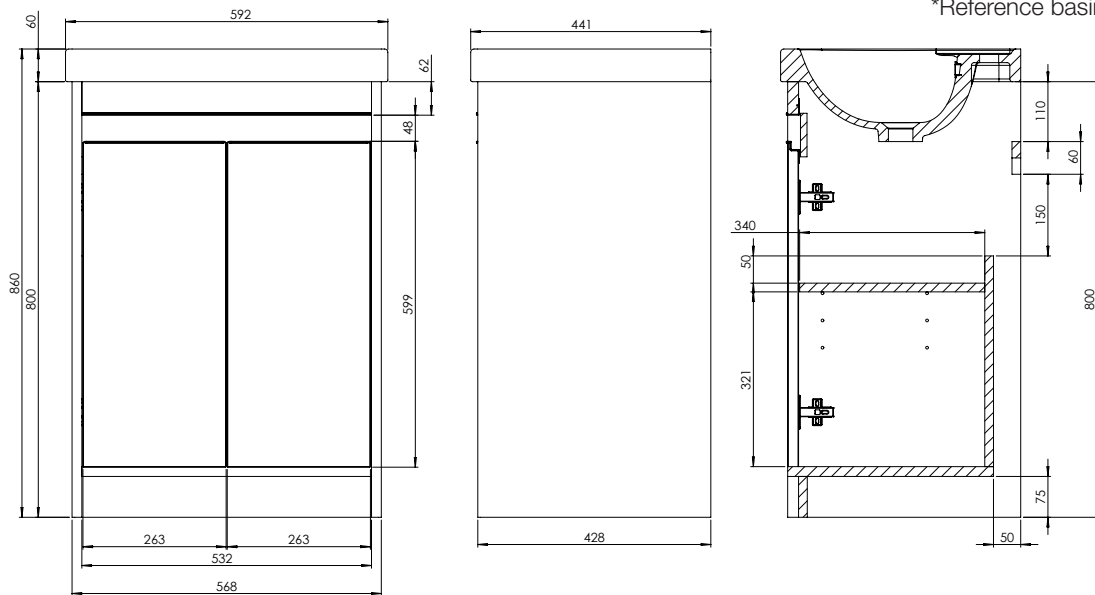

Diagrams not to scale
All dimensions in mm
Tolerance of +/-5mm
Handle included in diagram

Materials

Carcass: 18mm painted MDF, 20mm painted MDF
Fascia Components: 20mm painted MDF

**Dimensions are subject to change, customers are advised to measure actual product before commencing installation.
***Fixing point dimensions are for guidance only/the positions of wall fixing must be checked when product is received.

FAQs

- Q: How big is the plumbing void?
A: 50mm
- Q: Are the handles fitted?
A: No, a choice of three finishes are available separately. These can be installed using the pilot holes on the rear of the drawer fascia.
- Q: Are the hinges soft close?
A: The hinges are both soft close and quick release.
- Q: How deep is the unit with door open?
A: Approx. depth with 90° hinge: 690mm
- Q: Can the doors be adjusted?
A: The door can be adjusted as detailed in the supplied instructions
- Q: Is the shelf removable?
A: Yes, there is one removable shelf.
- Q: What is the shelf capacity?
A: Shelf max. depth: 340mm.
- Q: How many shelves are there?
A: There is one shelf and a base within the unit.
- Q: Is the shelf adjustable?
A: Yes, the shelf is adjustable.
- Q: What is the interior finish of the unit?
A: The unit interior finish is dark grey.

NOTE: Colours unique to R2 - No RAL Code available