

# Technical Data Sheet

# ROPER RHODES®

## Ceiling Head

SVHEAD34 (Chrome), SVHEAD 92 (Brushed Nickel), SVHEAD93 (Brushed Bronze)

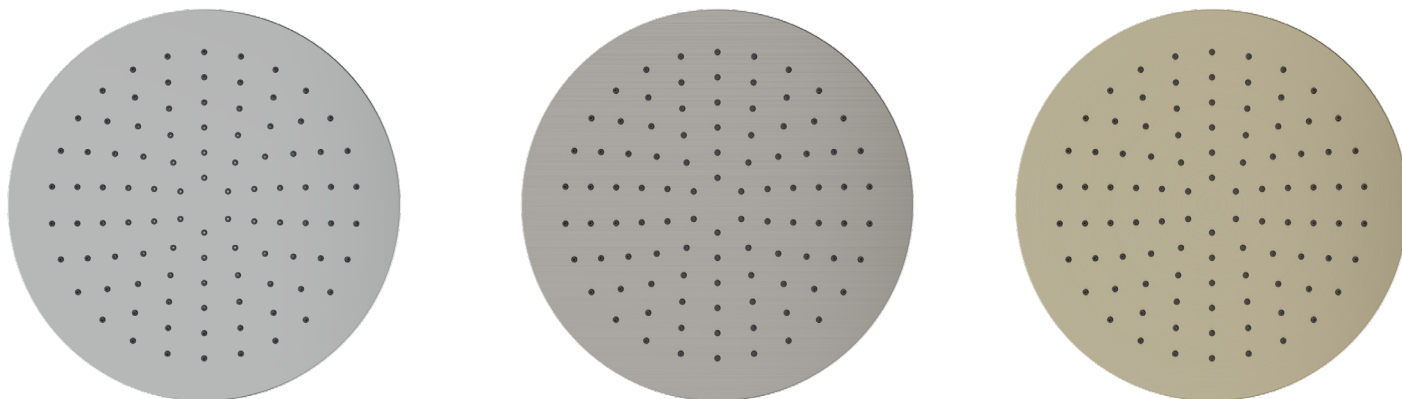

## Dimensions

Diagrams not to scale. All dimensions in mm (tolerance of +/-5mm)

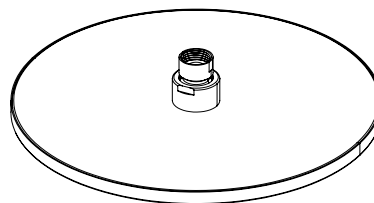
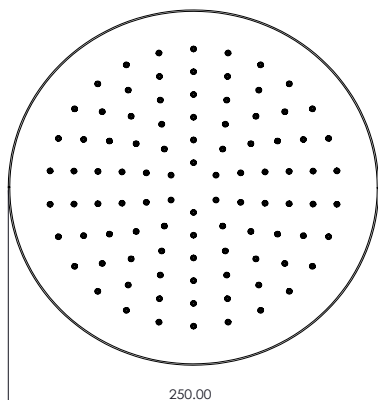
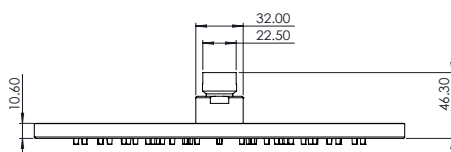

## FAQs

**What is the size of the connections?** The valve uses 1/2" connections.

**Can I have both shower options on at the same time?** Yes

**What size Pipework do i need?** 15mm

**Is it suitable for stud walls?** It is recommended you use CLS size 89mm depth within the wall

**Does the valve include isolation points?** Yes

**What is the recommended operating pressure?** 1.0bar

**Can the system be mounted vertically and horizontally?** Yes