

Technical Data Sheet

ROPER RHODES®

Shower Systems

No.	Description	Code	Fixings Included
1	Unity Dual Function Shower System	SVSET171	YES



FLOW RATE DATA IS TESTED UNDER LABORATORY CONDITIONS: ACTUAL FLOW RATE MAY VARY DEPENDING ON DOMESTIC SUPPLY AND ACCESSORIES

Minimum Pressure:	0.5 BAR
Inlet Pressure	Flow Rate (l/min)
0.2bar	4
0.3bar	5
0.5bar	7
1bar	8.5
2bar	11.5

Dimensions - Overview

Diagrams not to scale. All dimensions in mm (tolerance of +/-5mm)

Diagrams not to scale. All dimensions in mm (tolerance of +/-5mm)

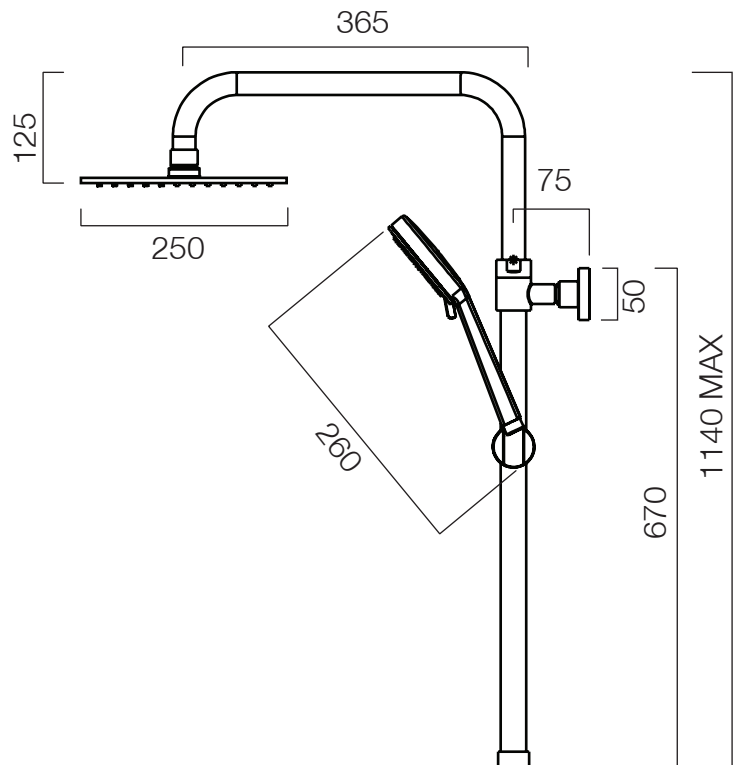
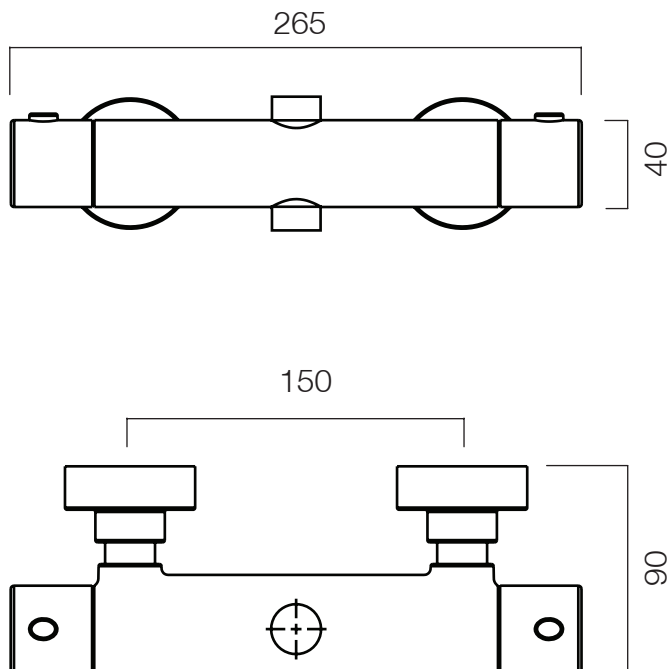

FAQs

How tall is the riser rail? Adjustable height - maximum 1140mm

How long is the shower hose? 1.5m

What is the minimum recommended pressure for the valve? 0.5BAR

What is the valve connection size? 3/4" threaded inlets / 1/2" threaded outlet

Materials:

Riser - Stainless Steel

Valve - Chrome Plated Zinc

Cover Plates - Stainless Steel

Slider - ABS

Shower Hose - PVC

Handset - ABS

Technical Data Sheet

ROPER RHODES®

Shower Systems

No.	Description	Code	Fixings Included
1	Unity Dual Function Shower System - Black	SVSET166	YES



FLOW RATE DATA IS TESTED UNDER LABORATORY CONDITIONS: ACTUAL FLOW RATE MAY VARY DEPENDING ON DOMESTIC SUPPLY AND ACCESSORIES

Minimum Pressure:	0.5 BAR
Inlet Pressure	Flow Rate (l/min)
0.2bar	4
0.3bar	5
0.5bar	7
1bar	8.5
2bar	11.5

Dimensions - Overview

Diagrams not to scale. All dimensions in mm (tolerance of +/-5mm)

Diagrams not to scale. All dimensions in mm (tolerance of +/-5mm)

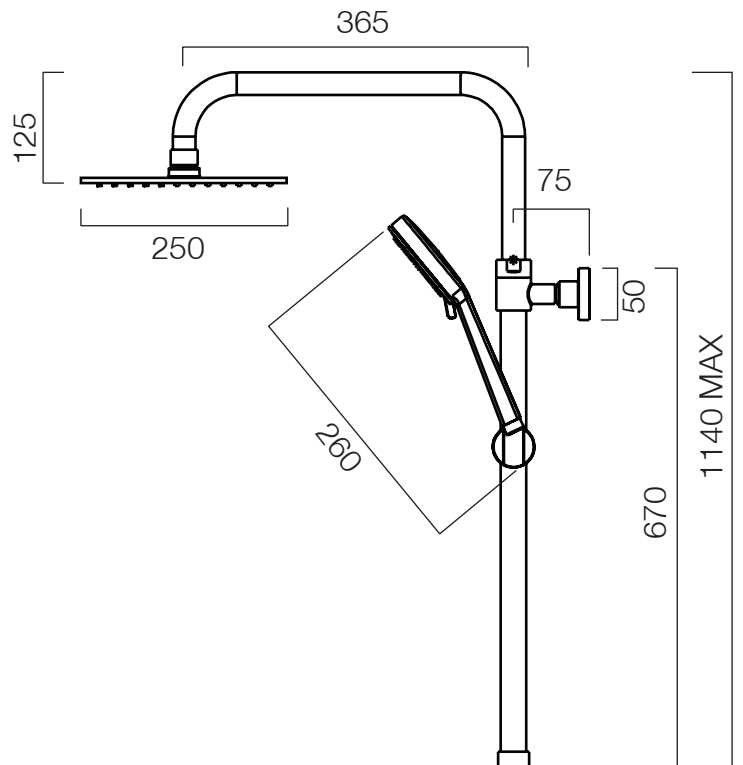
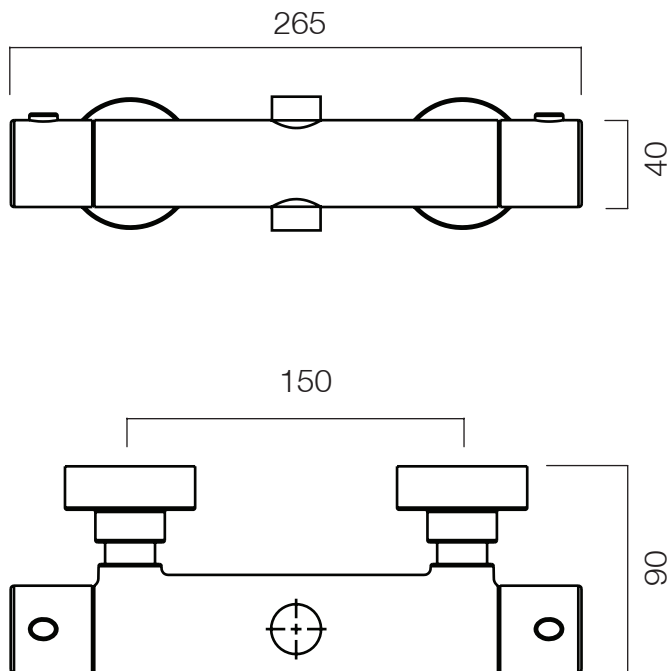

FAQs

How tall is the riser rail? Adjustable height - maximum 1140mm

How long is the shower hose? 1.5m

What is the minimum recommended pressure for the valve? 0.5BAR

What is the valve connection size? 3/4" threaded inlets / 1/2" threaded outlet

Materials:

Riser - Stainless Steel

Valve - Chrome Plated Zinc

Cover Plates - Stainless Steel

Slider - ABS

Shower Hose - PVC

Handset - ABS

Technical Data Sheet

ROPER RHODES®

Shower Systems

No.	Description	Code	Fixings Included
1	Unity Dual Function Shower System	SVSET168	YES



FLOW RATE DATA IS TESTED UNDER LABORATORY CONDITIONS: ACTUAL FLOW RATE MAY VARY DEPENDING ON DOMESTIC SUPPLY AND ACCESSORIES

Minimum Pressure:	0.5 BAR
Inlet Pressure	Flow Rate (l/min)
0.2bar	4
0.3bar	5
0.5bar	7
1bar	8.5
2bar	11.5

Dimensions - Overview

Diagrams not to scale. All dimensions in mm (tolerance of +/-5mm)

Diagrams not to scale. All dimensions in mm (tolerance of +/-5mm)

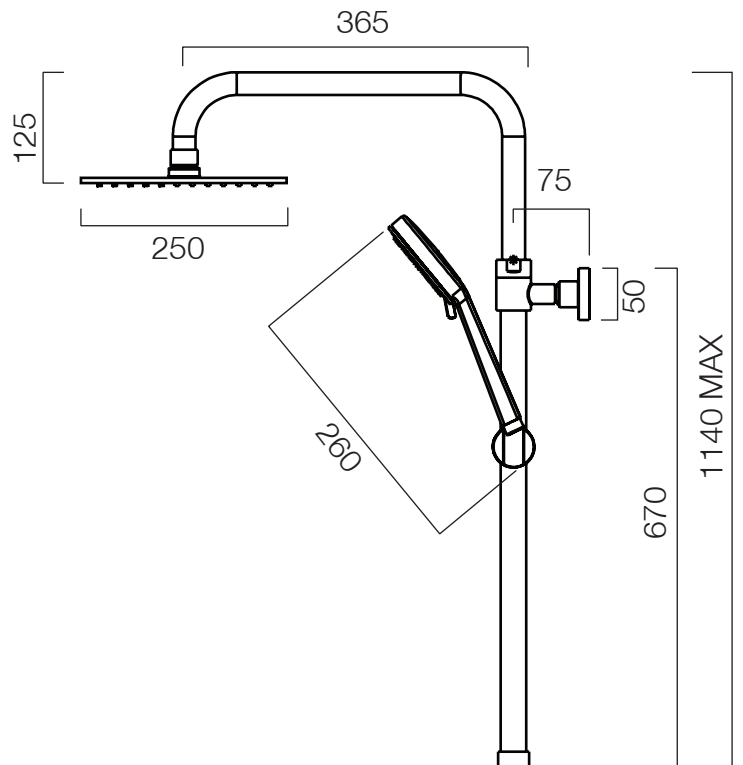
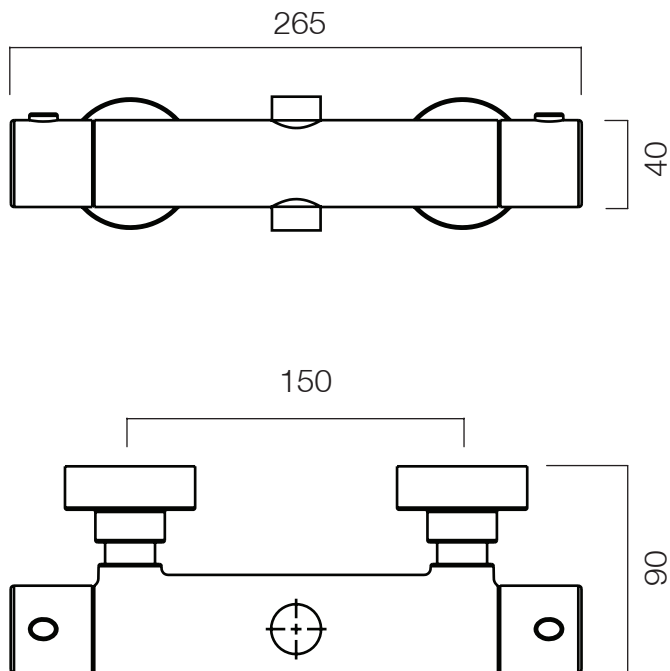

FAQs

How tall is the riser rail? Adjustable height - maximum 1140mm

How long is the shower hose? 1.5m

What is the minimum recommended pressure for the valve? 0.5BAR

What is the valve connection size? 3/4" threaded inlets / 1/2" threaded outlet

Materials:

Riser - Stainless Steel

Valve - Chrome Plated Zinc

Cover Plates - Stainless Steel

Slider - ABS

Shower Hose - Stainless Steel

Handset - ABS