

Faber Dual Function Bar Valve Shower System

SVSET226 (Chrome) SVSET227 (Brushed Nickel) SVSET228 (Brushed Bronze)



FLOW RATE DATA IS TESTED UNDER LABORATORY CONDITIONS: ACTUAL FLOW RATE MAY VARY DEPENDING ON DOMESTIC SUPPLY AND ACCESSORIES

Minimum Pressure:	1 BAR
Pressure:	Flow Rate (l/min)
1 BAR	10.85
2 BAR	16
3 BAR	19.8
4 BAR	23

Dimensions Diagrams not to scale. All dimensions in mm (tolerance of +/-5mm)

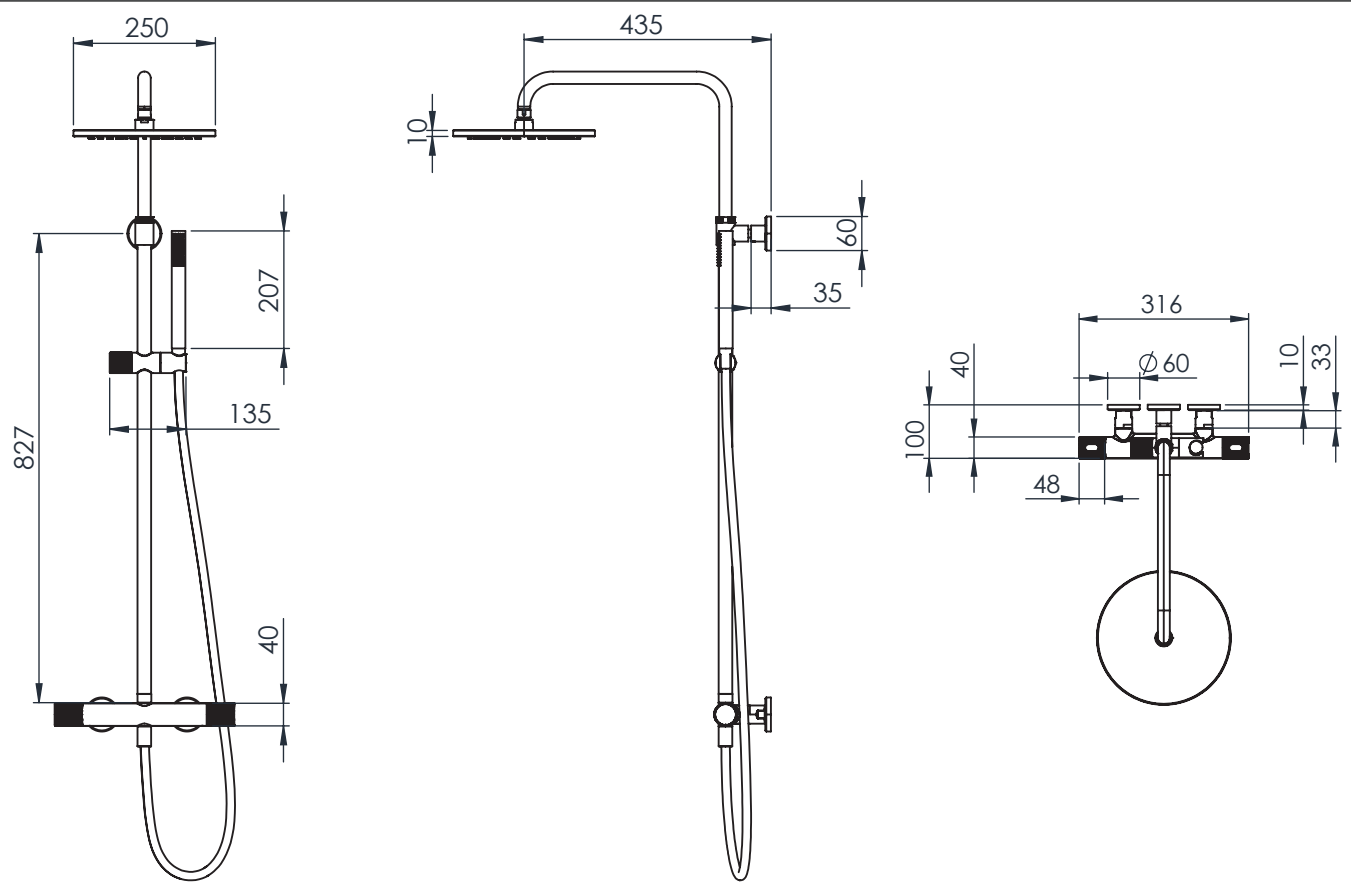

FAQs

- Does this shower system come with plumbing connections?** Yes, this bar valve comes with a colour matched quick fixing kit.
- What is the height range of the riser rail?** The riser rail can be adjust so that the system has an overall height of 1015mm to 1450mm.
- How long is the shower hose?** The shower hose is 1.5m long.
- What size are the inlet and outlet sizes?** The outlets of the shower valve are 1/2"BSP. The inlets on the bar valve are 3/4"BSP.
- What size pipework should I use?** The quick fixing kit supplied with this shower is designed to use 15mm pipework.
- How should I clean this product?** We recommend using only a damp cloth and warm water. Do NOT use abrasive cleaning products.