

Technical Data Sheet

SERENITY 600mm Floor Mounted Unit

What's in the box: 1x SN6017-XX + Fixings

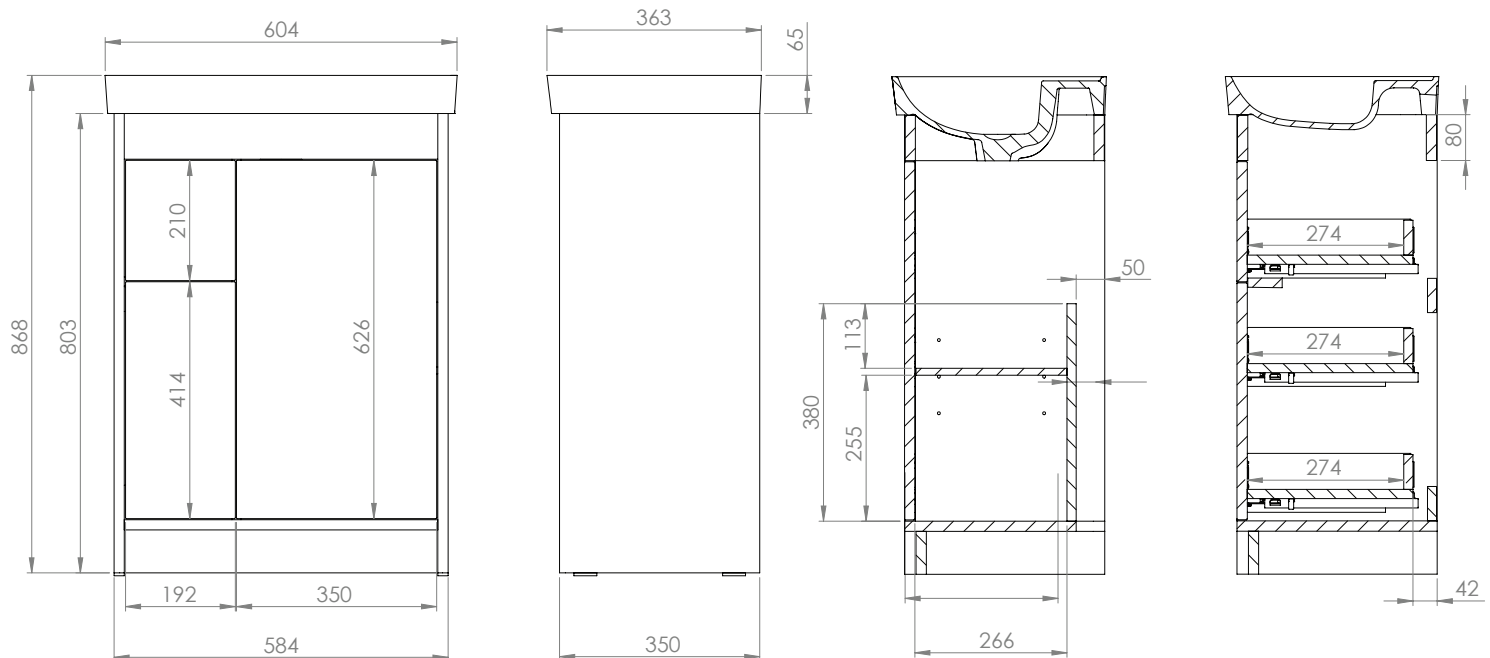

Diagrams not to scale
All dimensions in mm
Tolerance of +/-5mm

Materials

Carcass: 18mm - 16mm Painted/ PVC MDF
Fascia Components: 18mm Painted/ PVC MDF

**Dimensions are subject to change, customers are advised to measure actual product before commencing installation.

***Fixing point dimensions are for guidance only/the positions of wall fixing must be checked when product is received

FAQs

Q: How big is the plumbing void?

A: 50mm.

Q: Are the handles fitted?

A: No, handles need fixing.

Q: Are the hinges soft close?

A: The hinges are both soft close and quick release.

Q: Are the runners soft close?

A: The runners are soft close and quick release.

Q: Can the doors be adjusted?

A: The doors can be adjusted as detailed in the supplied instructions.

Q: Can the drawers be adjusted?

A: The drawers can be adjusted as detailed in the supplied instructions.

Q: How deep is the unit with doors open?

A: Approx. 680mm at 90°.

Q: Is the shelf adjustable?

A: Yes, the shelf can be adjusted.

Q: What is the shelf capacity?

A: Shelf max depth: 260mm.

Q: How many shelves are there?

A: There is one shelf and a base within the unit.

Q: What is the interior finish of the unit?

A: The unit interior is dark grey.

NOTE: Colours unique to R2 - No RAL Code available