

Elan Basin Mixer With Click Waste

T521102 (Chrome) T521104 (Brushed Brass) T521106 (Brushed Nickel)

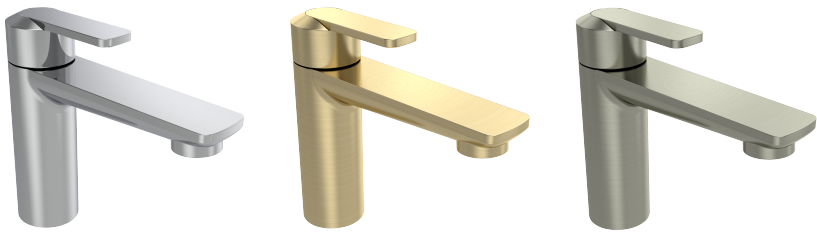

FLOW RATE DATA IS TESTED UNDER
LABORATORY CONDITIONS: ACTUAL
FLOW RATE MAY VARY DEPENDING ON
DOMESTIC SUPPLY AND ACCESSORIES

Minimum Pressure:	0.5 BAR
Pressure:	Flow Rate (l/min)
0.5 BAR	5
1 BAR	7
2 BAR	10.2
3 BAR	12.5

Dimensions

Diagrams not to scale. All dimensions in mm (tolerance of +/-5mm)

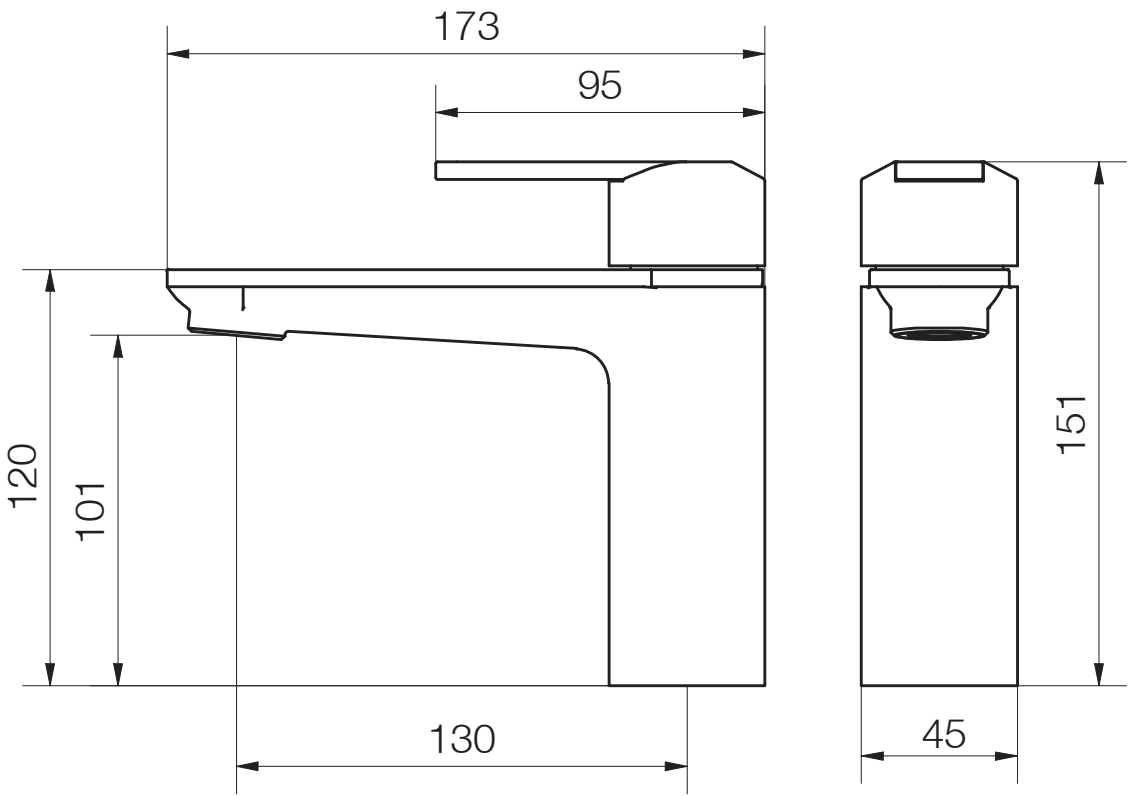

FAQs

- Does a click waste come with this product?** Yes, a click-waste is supplied with this product.
- What plumbing connections are supplied with this product?** 1/2" BSP captive nut braided hoses are supplied.
- How should I clean this product?** We recommend using only a damp cloth and warm water. Do NOT use abrasive cleaning products.