

TECHNICAL DATA SHEET

Cistern Sensor Flush Kit - TR9031

NO.	Description	Product Code	Fixings included	Gross Weight
1	Cistern Sensor Flush Kit	TR9031	YES	25KG

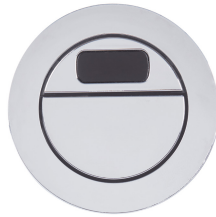

Parts Guide

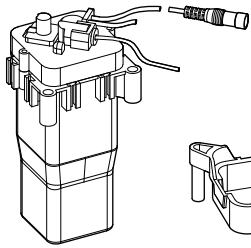

1x Control Box



1x Battery Box Cradle



1x Battery Box

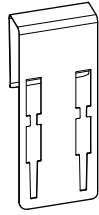

1x Stainless Steel Hanger

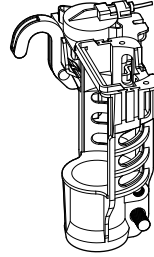

1x Clamp and Pneumatic Hook

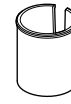

1x Clamp Collar

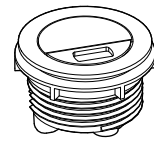

1x Button with Securing Nut

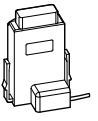

1x IR Sensor

FAQs

Q - Which WCs is this compatible with?

A - This is compatible with any paddle operated flush valve with a cistern lid hole from 38mm to 46mm

It is compatible with the following Roper Rhodes Group Ranges:

Roper Rhodes

Minerva

Geo, Cover, Accent (when purchased with compatible flush valve TR9033)

Tavistock

Structure, Ion, Micra, Lansdown, Orbit

Vibe (when purchased with compatible flush valve TR9033)

R2

Minerva, Langford, Radar, Debut

Q - How do I activate the reduced/full flush?

A - The reduced flush is activated by waving your hand over the sensor. The full flush is activated by holding your hand over the sensor for 1 second.

Q - How much room is required around the sensor

A - You should leave around 30cm of clear room above the sensor to prevent it from being triggered when not required,

Q - How can use this product if I don't have a paddle operated flush valve?

A - A paddle operated flush valve can be retro-fitted and can purchased using the code TR9033.

Q - What type of batteries does this product take?

A - 4 x AA with an expected battery life of 12 months.

Q - Is this product supplied with batteries?

A - No.

Q - Can the toilet be flushed when the batteries run out?

A - Yes, the button still has a manual full flush option.

Q - Is there an installation video?

A - Yes, follow the QR code on the instructions or below, or head to our website.

QUICK INSTALLATION GUIDE

For a quick installation guide, follow the instructional video by scanning the QR code to the right on your smart device:

